

GENERAL CONSTRUCTION NOTES:

- 1.) PRIOR TO ANY CONSTRUCTION WITHIN ANY EXISTING PUBLIC RIGHT-OF-WAY, INCLUDING CONNECTION TO ANY EXISTING ROAD, A PERMIT SHALL BE OBTAINED FROM THE VIRGINIA DEPARTMENT OF TRANSPORTATION (VDOT). THIS PLAN AS DRAWN MAY NOT ACCURATELY REFLECT THE REQUIREMENTS OF THE PERMIT. WHERE ANY DISCREPANCIES OCCUR THE REQUIREMENTS OF THE PERMIT SHALL GOVERN.
- 2). ALL MATERIALS AND CONSTRUCTION METHODS SHALL CONFORM TO CURRENT SPECIFICATIONS AND STANDARDS OF VDOT UNLESS OTHERWISE NOTED.
- 3.) EROSION AND SILTATION CONTROL MEASURES SHALL BE PROVIDED IN ACCORDANCE WITH THE APPROVED EROSION CONTROL PLAN AND SHALL BE INSTALLED PRIOR TO ANY CLEARING, GRADING OR OTHER CONSTRUCTION.
- 4.) ALL SLOPES AND DISTURBED AREAS ARE TO BE FERTILIZED, SEEDED AND MULCHED.
- 5.) THE MAXIMUM ALLOWABLE SLOPE IS 2:1 (HORIZONTAL:VERTICAL). WHERE REASONABLY OBTAINABLE, LESSER SLOPES OF 3:1 OR BETTER ARE TO BE ACHIEVED.
- 6.) PAVED, RIP-RAP OR STABILIZATION MAT LINED DITCH MAY BE REQUIRED WHEN IN THE OPINION OF THE COUNTY ENGINEER, OR DESIGNEE, IT IS DEEMED NECESSARY IN ORDER TO STABILIZE A DRAINAGE CHANNEL.
- 7.) ALL TRAFFIC CONTROL SIGNS SHALL CONFORM WITH THE VIRGINIA MANUAL FOR UNIFORM TRAFFIC CONTROL DEVICES.
- 8.) UNLESS OTHERWISE NOTED ALL CONCRETE PIPE SHALL BE REINFORCED CONCRETE PIPE – CLASS III.
- 9.) ALL EXCAVATION FOR UNDERGROUND PIPE INSTALLATION MUST COMPLY WITH OSHA STANDARDS FOR THE CONSTRUCTION INDUSTRY (29 CFR PART 1926).

GENERAL CONSTRUCTION NOTES FOR EROSION AND SEDIMENT CONTROL PLANS:

- 1.) THE PLAN APPROVING AUTHORITY MUST BE NOTIFIED ONE WEEK PRIOR TO THE PRE-CONSTRUCTION CONFERENCE, ONE WEEK PRIOR TO THE COMMENCEMENT OF LAND DISTURBING ACTIVITY, AND ONE WEEK PRIOR TO THE FINAL INSPECTION.
- 2.) ALL EROSION AND SEDIMENT CONTROL MEASURES WILL BE CONSTRUCTED AND MAINTAINED ACCORDING TO MINIMUM STANDARDS AND SPECIFICATIONS OF THE VIRGINIA EROSION AND SEDIMENT CONTROL HANDBOOK AND VIRGINIA REGULATIONS VR 625-02-00 EROSION AND SEDIMENT CONTROL REGULATIONS.
- 3.) ALL EROSION AND SEDIMENT CONTROL MEASURES ARE TO BE PLACED PRIOR TO OR AS THE FIRST STEP IN CLEARING.
- 4.) A COPY OF THE APPROVED EROSION AND SEDIMENT CONTROL PLAN SHALL BE MAINTAINED ON THE SITE AT ALL TIMES.
- 5.) PRIOR TO COMMENCING LAND DISTURBING ACTIVITIES IN AREAS OTHER THAN INDICATED ON THESE PLANS (INCLUDING, BUT NOT LIMITED TO, OFF-SITE BORROW OR WASTE AREAS), THE CONTRACTOR SHALL SUBMIT A SUPPLEMENTARY EROSION CONTROL PLAN TO THE OWNER FOR REVIEW AND APPROVAL BY THE PLAN APPROVING AUTHORITY. ALBEMARLE COUNTY ENGINEERING FINAL PLAN GENERAL NOTES PAGE 3 OF 4 (16 JUN 2005)
- 6.) THE CONTRACTOR IS RESPONSIBLE FOR INSTALLATION OF ANY ADDITIONAL EROSION CONTROL MEASURES NECESSARY TO PREVENT EROSION AND SEDIMENTATION AS DETERMINED BY THE PLAN APPROVING AUTHORITY.
- 7.) ALL DISTURBED AREAS ARE TO DRAIN TO APPROVED SEDIMENT CONTROL MEASURES AT ALL TIMES DURING LAND DISTURBING ACTIVITIES AND DURING SITE DEVELOPMENT UNTIL FINAL STABILIZATION IS ACHIEVED.
- 8.) DURING DEWATERING OPERATIONS, WATER WILL BE PUMPED INTO AN APPROVED FILTERING DEVICE.
- 9.) THE CONTRACTOR SHALL INSPECT ALL EROSION CONTROL MEASURES PERIODICALLY AND AFTER EACH RUNOFF PRODUCING RAINFALL EVENT. ANY NECESSARY REPAIRS OR CLEANUP TO MAINTAIN THE EFFECTIVENESS OF THE EROSION CONTROL DEVICES SHALL BE MADE IMMEDIATELY.
- 10.) ALL FILL MATERIAL TO BE TAKEN FROM AN APPROVED, DESIGNATED BORROW AREA.
- 11.) ALL WASTE MATERIALS SHALL BE TAKEN TO AN APPROVED WASTE AREA. EARTH FILL SHALL BE INERT MATERIALS ONLY, FREE OF ROOTS, STUMPS, WOOD, RUBBISH, AND OTHER DEBRIS.
- 12.) BORROW OR WASTE AREAS ARE TO BE RECLAIMED WITHIN 7 DAYS OF COMPLETION PER ZONING ORDINANCE SECTION 5.1.28.
- 13.) ALL INERT MATERIALS SHALL BE TRANSPORTED IN COMPLIANCE WITH SECTION 13-301 OF THE CODE OF ALBEMARLE.
- 14.) BORROW, FILL OR WASTE ACTIVITY INVOLVING INDUSTRIAL-TYPE POWER EQUIPMENT SHALL BE LIMITED TO THE HOURS OF 7:00AM TO 9:00PM.
- 15.) BORROW, FILL OR WASTE ACTIVITY SHALL BE CONDUCTED IN A SAFE MANNER THAN MAINTAINS LATERAL SUPPORT, OR ORDER TO MINIMIZE ANY HAZARD TO PERSONS, PHYSICAL DAMAGE TO ADJACENT LAND AND IMPROVEMENTS, AND DAMAGE TO ANY PUBLIC STREET BECAUSE O SLIDES, SINKING, OR COLLAPSE.
- 16.) THE DEVELOPER SHALL RESERVE THE RIGHT TO INSTALL, MAINTAIN, REMOVE OR CONVERT TO PERMANENT STORMWATER MANAGEMENT FACILITIES WHERE APPLICABLE ALL EROSION CONTROL MEASURES REQUIRED BY THIS PLAN REGARDLESS OF THE SALE OF ANY LOT, UNIT, BUILDING OR OTHER PORTION OF THE PROPERTY.
- 17.) TEMPORARY STABILIZATION SHALL BE TEMPORARY SEEDING AND MULCHING. SEEDING IS TO BE AT 75 LBS/ACRE, AND IN THE MONTHS OF SEPTEMBER TO FEBRUARY TO CONSIST A 50/50 MIX OF ANNUAL RYEGRASS AND CEREAL WINTER RYE, OR IN MARCH AND APRIL TO CONSIST OF ANNUAL RYE, OR MAY THROUGH AUGUST TO CONSIST OF GERMAN MILLET. STRAW MULCH IS TO BE APPLIED AT 80LBS/100SF. ALTERNATIVES ARE SUBJECT TO APPROVED BY THE COUNTY EROSION CONTROL INSPECTOR.
- 18.) PERMANENT STABILIZATION SHALL BE LIME AND FERTILIZER, PERMANENT SEEDING, AND MULCH. AGRICULTURAL GRADE LIMESTONE SHALL BE APPLIED AT 90LBS/1000SF, INCORPORATED INTO THE TOP 4-6 INCHES OF SOIL. FERTILIZER SHALL BE APPLIED AT 1000LBS/ACRE AND CONSIST OF A 10-20-10 NUTRIENT MIX. PERMANENT SEEDING SHALL BE APPLIED AT 180LBS/ACRE AND CONSIST OF 95% KENTUCKY 31 OR TALL FESCUE AND 0-5% PERENNIAL RYEGRASS OR KENTUCKY BLUEGRASS. STRAW MULCH IS TO BE APPLIED AT 80LBS/100SF. ALTERNATIVES ARE SUBJECT TO APPROVED BY THE COUNTY EROSION CONTROL INSPECTOR.
- 19.) MAINTENANCE: ALL MEASURES ARE TO BE INSPECTED WEEKLY AND AFTER EACH RAINFALL. ANY DAMAGE OR CLOGGING TO STRUCTURAL MEASURES IS TO BE REPAIR IMMEDIATELY. SILT TRAPS ARE TO BE CLEANED WHEN 50% OF THE WET STORAGE VOLUME IS FILLED WITH SEDIMENT. ALL SEEDED AREAS ARE TO BE RESEEDED WHEN NECESSARY TO ACHIEVE A GOOD STAND OF GRASS. SILT FENCE AND DIVERSION DYKES WHICH ARE COLLECTING SEDIMENT TO HALF THEIR HEIGHT MUST BE CLEANED AND REPAIRED IMMEDIATELY.
- 20.) ALL TEMPORARY EROSION AND SEDIMENT CONTROL MEASURES ARE TO BE REMOVED WITHIN 30 DAYS OF FINAL SITE STABILIZATION, WHEN MEASURES ARE NO LONGER NEEDED, SUBJECT TO APPROVAL BY THE COUNTY EROSION CONTROL INSPECTOR.

EROSION AND SEDIMENT CONTROL NARRATIVE

ALL EROSION AND SEDIMENT CONTROL MEASURES SHALL BE INSTALLED IN ACCORDANCE WITH THE VIRGINIA EROSION AND SEDIMENT CONTROL HANDBOOK.

CONTROLS UTILIZED:

- 1.) CONSTRUCTION ENTRANCE (CE) – INSTALL AT THE ENTRANCE INTO THE PROPERTY ONCE BEYOND TMP 63-19. ENTRANCE TO BE INSTALLED AS PER SPECIFICATIONS OUTLINED IN 3.02 OF SAID HANDBOOK.
- 2.) SILTFENCE (SF) – INSTALL AS SHOWN ON EROSION AND SEDIMENT CONTROL PLANS. ADDITIONAL FENCING MAY BE REQUIRED IF SO DEEMED NECESSARY BY THE COUNTY OF ALBEMARLE. FENCE TO BE INSTALLED AS PER SPECIFICATIONS OUTLINED IN 3.05 OF SAID HANDBOOK.
- 3.) CULVERT INLET PROTECTION (CIP) – INSTALL WHERE STORM PIPES ARE INSTALLED. PROTECTION TO BE INSTALLED AS PER SPECIFICATIONS OUTLINED IN 3.08 OF SAID HANDBOOK.
- 4.) DIVERSION DITCH (DD) – INSTALL AS SHOWN ON EROSION AND SEDIMENT CONTROL PLANS. DITCHES TO BE INSTALLED AS PER SPECIFICATIONS OUTLINED IN 3.12 OF SAID HANDBOOK.
- 5.) SEDIMENT TRAP(S) (ST) – INSTALL AS SHOWN ON EROSION AND SEDIMENT CONTROL PLANS. TRAPS TO BE INSTALLED AS PER SPECIFICATIONS OUTLINED IN 3.13 OF SAID HANDBOOK. SEE SEDIMENT TRAP SCHEDULE FOR DESIGN INFORMATION.
- 6.) OUTLET PROTECTION (OP) – INSTALL WHERE STORM PIPES ARE INSTALLED. PROTECTION TO BE INSTALLED AS PER SPECIFICATIONS OUTLINED IN 3.18 OF SAID HANDBOOK.
- 7.) TEMPORARY SEEDING (TS) – SEEDING SHALL BE APPLIED WITHIN 7 DAYS TO AREAS THAT MAY REMAIN UNDISTURBED FOR MORE THAN 30 DAYS. SEEDING TO BE INSTALLED AS PER SPECIFICATIONS OUTLINED IN 3.31 OF SAID HANDBOOK.
- 8.) PERMANENT SEEDING (PS) – SEEDING SHALL BE APPLIED WITHIN 7 DAYS TO AREAS INDICATED HEREON. ADDITIONAL SEEDING MAY BE DEEMED NECESSARY BY THE COUNTY OF VIRGINIA. SEEDING TO BE INSTALLED AS PER SPECIFICATIONS OUTLINED IN 3.32 OF SAID HANDBOOK.
- 9.) MULCHING (MU) – MULCH COMPRISED OF PLANT RESIDUES (STRAW PREFERABLY) OR OTHER SUITABLE MATERIALS SHOULD BE APPLIED TO PROMOTE PLANT GROWTH AND REDUCE THE RISK OF SOIL EROSION. MULCH TO BE INSTALLED AS PER SPECIFICATIONS OUTLINED IN 3.35 OF SAID HANDBOOK.
- 10.) DUST CONTROL (DC) – NECESSARY DUST CONTROL OPERATIONS SHALL BE ADMINISTERED IN A MANOR TO CONTROL THE AIRBORNE MOVEMENT OF SEDIMENT AS PER SPECIFICATIONS OUTLINED IN 3.39 OF SAID HANDBOOK.

CONTROL INSTALLATION SEQUENCE:

- 1.) INSTALL CONSTRUCTION ENTRANCE AT LOCATION NOTED ABOVE AND ON PLANS.
- 2.) INSTALL SILT FENCING, DIVERSION DITCHES, AND SEDIMENT TRAPS AS SHOWN HEREON.
- 3.) INSTALL STORM DRAINAGE PIPES, INETS, AND END SECTIONS ALONG WITH CULVERT INLET PROTECTION AND OUTLET PROTECTION.
- 4.) CONTACT COUNTY OF ALBEMARLE FOR INSPECTION AND APPROVAL OF CONTROL MEASURES INSTALLED.
- 5.) COMMENCE CONSTRUCTION OF BUILDING PAD AND DRIVEWAY AS SHOWN HEREON WHILE MAINTAINING AND MONITORING EROSION CONTROL MEASURES INSTALLED AT THIS POINT.
- 6.) UPON FINAL SITE GRADING APPLY PERMANENT SEEDING ON ALL SLOPES AND AREAS TO BE GRASSED.

# EROSION AND SEDIMENT CONTROL PLAN

## TMP 06300-00-00-019E0

### RIVANNA MAGISTERIAL DISTRICT

### ALBEMARLE COUNTY, VIRGINIA

SURVEYOR NOTES:

- 1.) PREPARED FOR DOBSON HOMES, INC.
- 2.) THIS RESIDENTIAL SITE PLAN SHOWS THE FUTURE IMPROVEMENTS FOR TMP 06300-00-00-019E0. NO BOUNDARY SURVEY WAS PERFORMED BY THIS FIRM. THIS DOES NOT REPRESENT AN ACTUAL PHYSICAL SURVEY NOR IS IT THE INTENT TO REPRESENT POST CONSTRUCTION CONDITIONS.
- 3.) THIS PLAN WAS DONE WITHOUT THE BENEFIT OF CURRENT TITLE REPORT AND MAY NOT INDICATE ALL ENCUMBRANCES ON THE PROPERTY SHOWN HEREON.
- 4.) PROPERTY LIES WITHIN FLOOD ZONE "X"; NOT A F.E.M.A. DEFINED 100-YEAR FLOODPLAIN.
- 5.) DATUM'S USED:  
A.) HORIZONTAL – STATE SOUTH GRID – NAD 83  
B.) VERTICAL – NAVD88.
- 6.) CONTOURS SHOWN HEREON WERE DERIVED BY INFORMATION OBTAINED FROM THE COUNTY OF ALBEMARLE OFFICE OF GEOGRAPHIC. THIS FIRM HAS NOT VERIFIED NOR CERTIFIES TO THE AUTHENTICITY OF SAID CONTOURS.
- 7.) ALL EROSION AND SEDIMENT CONTROL MEASURES SHALL BE INSTALLED IN ACCORDANCE WITH THE VIRGINIA EROSION AND SEDIMENT CONTROL HANDBOOK. CONTRACTOR SHALL BE RESPONSIBLE FOR ALL PERMITS, IMPLEMENTATION, AND MAINTENANCE OF ALL EROSION AND SEDIMENT CONTROL MEASURES REQUIRED.
- 8.) THE STREAM BUFFER SHOWN HEREON SHALL BE MANAGED IN ACCORDANCE WITH THE ALBEMARLE COUNTY WATER PROTECTION ORDINANCE.
- 9.) PROPERTY MAY BE SUBJECT TO ADDITIONAL RESTRICTIONS OF RECORD.
- 10.) NO UNDERGROUND INVESTIGATION OF UTILITIES WAS PERFORMED. THE CONTRACTOR SHALL DETERMINE THE EXACT LOCATION OF ALL EXISTING UTILITIES BEFORE COMMENCING WORK. THE CONTRACTOR AGREES TO BE FULLY RESPONSIBLE FOR ANY AND ALL DAMAGES WHICH MIGHT BE OCCASIONED BY HIS OR HER FAILURE TO EXACTLY LOCATE AND PRESERVE ANY AND ALL UNDERGROUND UTILITIES.

SITE DATA:

- 1.) OWNER:  
LAWRENCE C. MARSHALL JR., AND  
LAWRENCE C. MARSHALL III  
D.B. 4656, PG. 696  
D.B. 811, PG. 219, 221 (PLAT)
- 2.) PARCEL IDENTIFICATION: TMP 06300-00-00-019E0.
- 3.) ZONING: RA (RURAL AGRICULTURE).
- 4.) CURRENT USE: LOGGING.
- 5.) SITE IS CURRENTLY UNDER LOGGING ACTIVITIES.
- 6.) SOIL CLASSIFICATION ON THIS SITE PER NATIONAL RESOURCES CONSERVATION SERVICES (NRCS) ARE WITHIN HYDROLOGIC GROUP "B". SOILS TYPES PER NRCS ARE 71D (RABUN CLAY LOAM, 15% TO 25% SLOPES), 71E (RABUN CLAY LOAM, 25% TO 45% SLOPES), AND 90B (GENERALLY IN STREAM BUFFER AREA)(UNISON VERY STONY SILT LOAM, 2% TO 7% SLOPES).

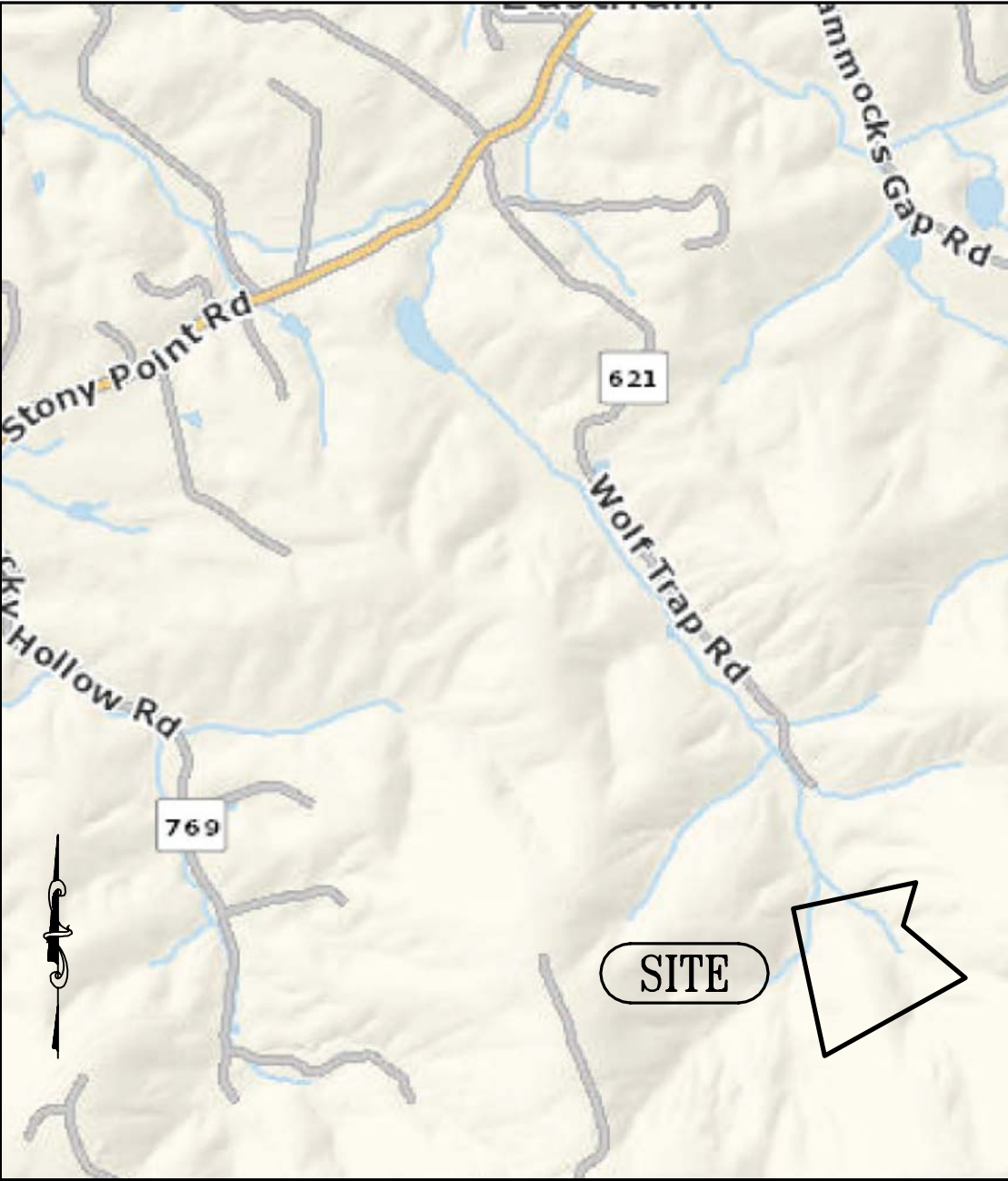

VICINITY MAP  
SCALE: 1" = 2,000'

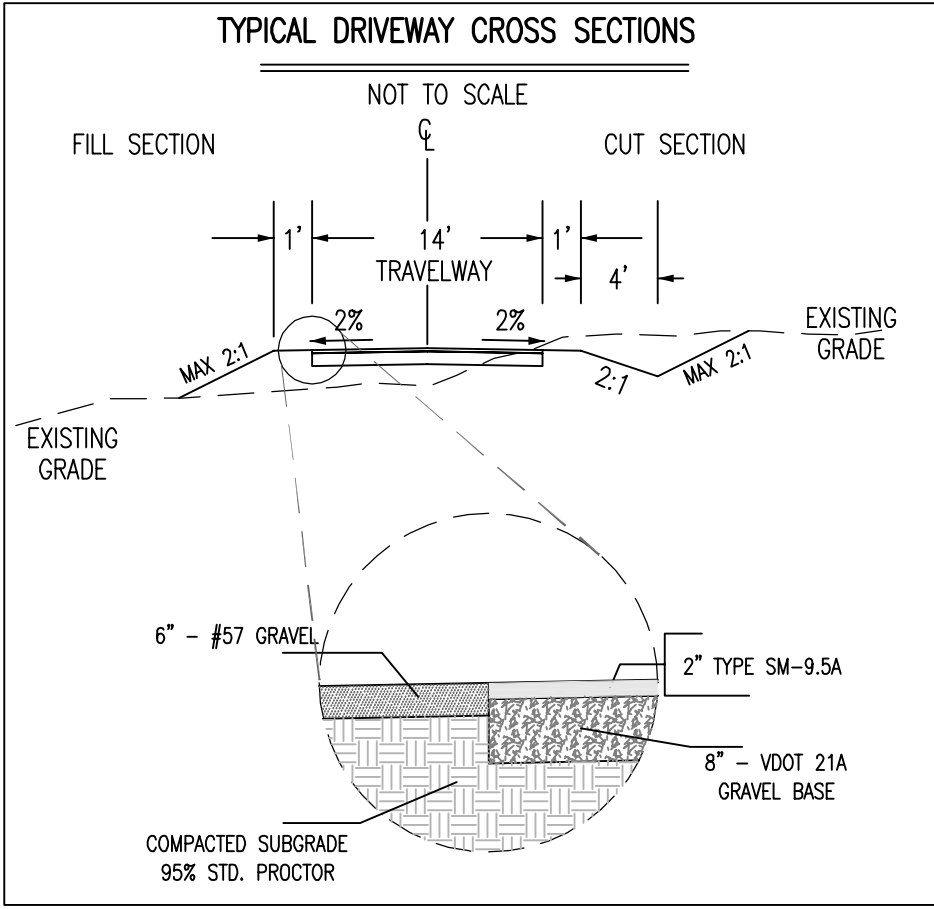

KIRK HUGHES  
&  
ASSOCIATES

LAND SURVEYORS AND PLANNERS  
222 EAST HIGH STREET  
CHARLOTTESVILLE, VA. 22902  
(804) 296-6942

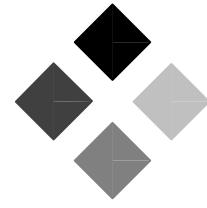

EROSION AND SEDIMENT CONTROL PLAN

TMP 06300-00-00-019E0

LAWRENCE C., JR AND LAWRENCE C. MARSHALL

RIVANNA MAGISTERIAL DISTRICT, ALBEMARLE COUNTY, VIRGINIA

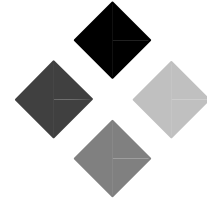

FILE NO.:

DWG. NO.:

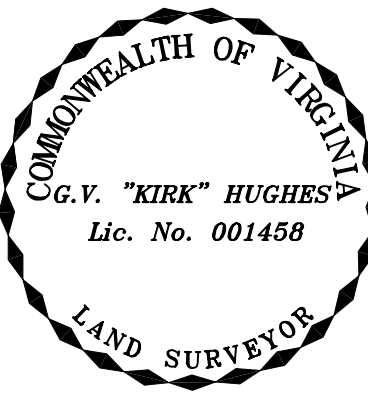

DATE: MAY 24, 2019

REVISION DATES:

OCTOBER 31, 2019

SCALE: SEE PLAN SHEETS

SHEET TITLE:

COVER  
SHEET

SHEET NO.:

A

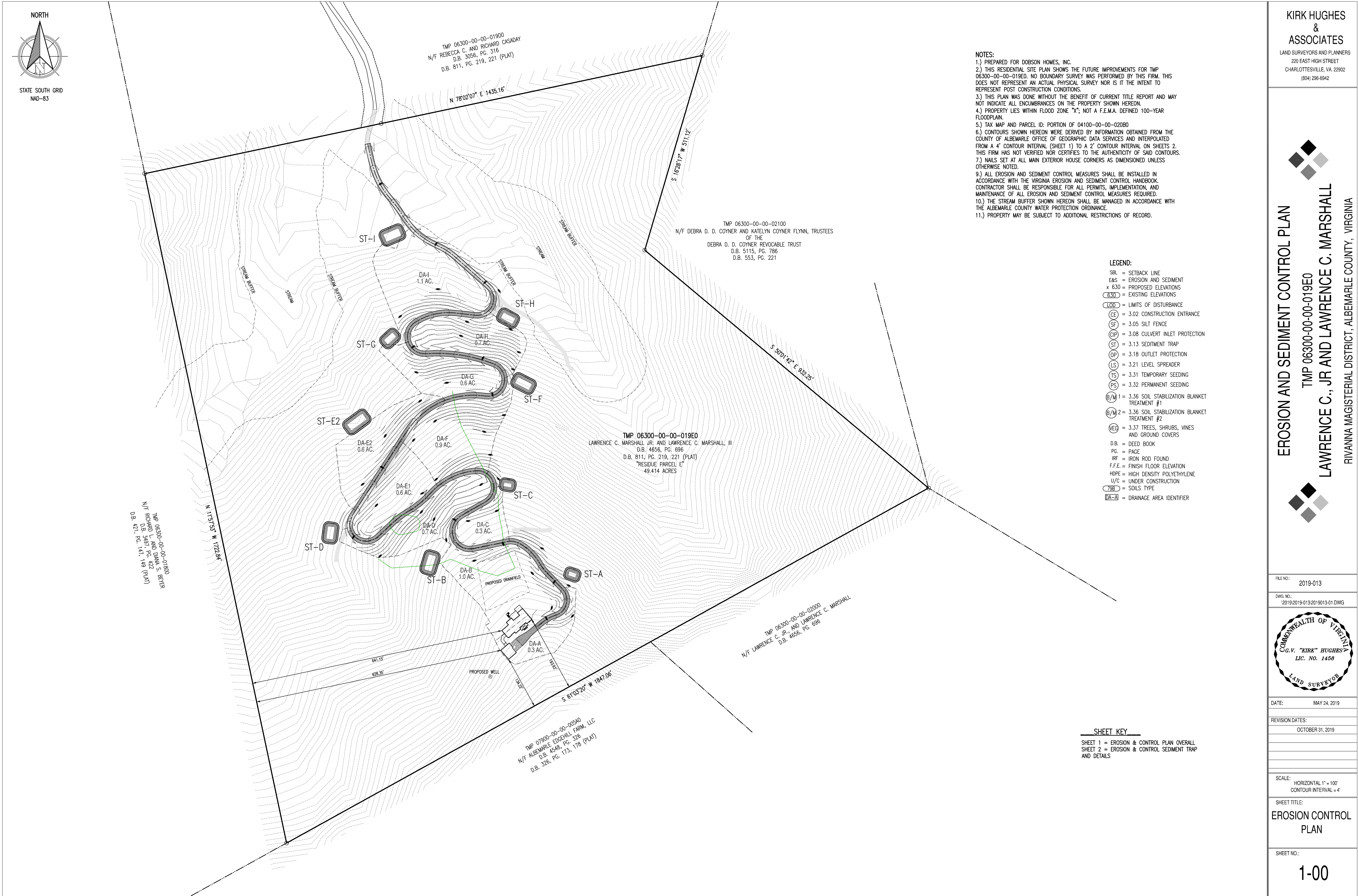

NOTES:  
1.) PREPARED FOR DOBSON HOMES, INC.  
2.) THIS RESIDENTIAL SITE PLAN SHOWS THE FUTURE IMPROVEMENTS FOR TMP 06300-00-00-019E0. NO BOUNDARY SURVEY WAS PERFORMED BY THIS FIRM. THIS DOES NOT REPRESENT AN ACTUAL PHYSICAL SURVEY NOR IS IT THE INTENT TO REPRESENT POST CONSTRUCTION CONDITIONS.  
3.) THIS PLAN WAS DONE WITHOUT THE BENEFIT OF CURRENT TITLE REPORT AND MAY NOT INDICATE ALL ENCUMBRANCES ON THE PROPERTY SHOWN HEREON.  
4.) PROPERTY LIES WITHIN FLOOD ZONE "X"; NOT A F.E.M.A. DEFINED 100-YEAR FLOODPLAIN.  
5.) TAX MAP AND PARCEL ID: PORTION OF 04100-00-00-020B0  
6.) CONTOURS SHOWN HEREON WERE DERIVED BY INFORMATION OBTAINED FROM THE COUNTY OF ALBEMARLE OFFICE OF GEOGRAPHIC DATA SERVICES AND INTERPOLATED FROM A 4' CONTOUR INTERVAL (SHEET 1) TO A 2' CONTOUR INTERVAL ON SHEETS 2. THIS FIRM HAS NOT VERIFIED NOR CERTIFIES TO THE AUTHENTICITY OF SAID CONTOURS.  
7.) NAILS SET AT ALL MAIN EXTERIOR HOUSE CORNERS AS DIMENSIONED UNLESS OTHERWISE NOTED.  
9.) ALL EROSION AND SEDIMENT CONTROL MEASURES SHALL BE INSTALLED IN ACCORDANCE WITH THE VIRGINIA EROSION AND SEDIMENT CONTROL HANDBOOK. CONTRACTOR SHALL BE RESPONSIBLE FOR ALL PERMITS, IMPLEMENTATION, AND MAINTENANCE OF ALL EROSION AND SEDIMENT CONTROL MEASURES REQUIRED.  
10.) THE STREAM BUFFER SHOWN HEREON SHALL BE MANAGED IN ACCORDANCE WITH THE ALBEMARLE COUNTY WATER PROTECTION ORDINANCE.  
11.) PROPERTY MAY BE SUBJECT TO ADDITIONAL RESTRICTIONS OF RECORD.

- LEGEND:
- SBL = SETBACK LINE
  - E&S = EROSION AND SEDIMENT
  - x 630 = PROPOSED ELEVATIONS
  - 630 = EXISTING ELEVATIONS
  - LOD = LIMITS OF DISTURBANCE
  - CE = 3.02 CONSTRUCTION ENTRANCE
  - SF = 3.05 SILT FENCE
  - CIP = 3.08 CULVERT INLET PROTECTION
  - ST = 3.13 SEDIMENT TRAP
  - OP = 3.18 OUTLET PROTECTION
  - LS = 3.21 LEVEL SPREADER
  - TS = 3.31 TEMPORARY SEEDING
  - PS = 3.32 PERMANENT SEEDING
  - E/N 1 = 3.36 SOIL STABILIZATION BLANKET TREATMENT #1
  - E/N 2 = 3.36 SOIL STABILIZATION BLANKET TREATMENT #2
  - VEG = 3.37 TREES, SHRUBS, VINES AND GROUND COVERS
  - D.B. = DEED BOOK
  - P.G. = PAGE
  - IRF = IRON ROD FOUND
  - F.F.E. = FINISH FLOOR ELEVATION
  - HDPE = HIGH DENSITY POLYETHYLENE
  - U/C = UNDER CONSTRUCTION
  - 78B = SOILS TYPE
  - DA-A = DRAINAGE AREA IDENTIFIER

SHEET KEY  
SHEET 1 = EROSION & CONTROL PLAN OVERALL  
SHEET 2 = EROSION & CONTROL SEDIMENT TRAP AND DETAILS

KIRK HUGHES & ASSOCIATES  
LAND SURVEYORS AND PLANNERS  
220 EAST HIGH STREET  
CHARLOTTESVILLE, VA. 22902  
(804) 296-6942

EROSION AND SEDIMENT CONTROL PLAN  
TMP 06300-00-00-019E0  
LAWRENCE C., JR AND LAWRENCE C. MARSHALL  
RIVANNA MAGISTERIAL DISTRICT, ALBEMARLE COUNTY, VIRGINIA

FILE NO.: 2019-013

DWG. NO.: 2019/2019-013/2019013-01.DWG

COMMONWEALTH OF VIRGINIA

G.V. "KIRK" HUGHES

LIC. NO. 1458

LAND SURVEYOR

DATE: MAY 24, 2019

REVISION DATES:  
OCTOBER 31, 2019

SCALE: HORIZONTAL 1" = 100'  
CONTOUR INTERVAL = 4'

SHEET TITLE:  
EROSION CONTROL PLAN

SHEET NO.: 1-00

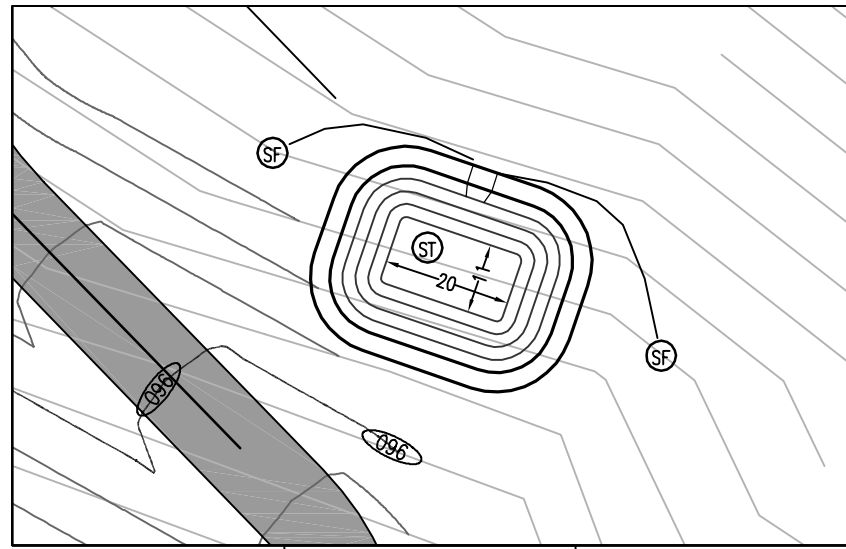

SEDIMENT TRAP "A"  
HORIZONTAL 1" = 30'

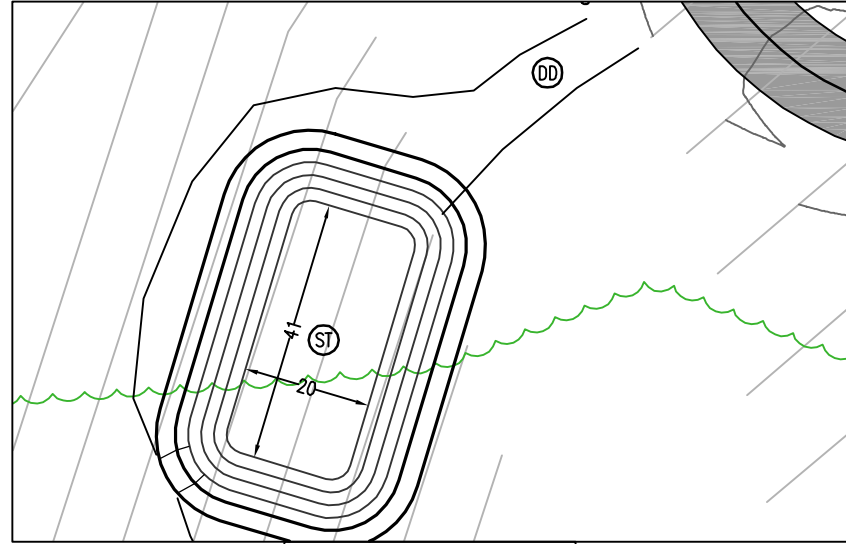

SEDIMENT TRAP "B"  
HORIZONTAL 1" = 30'

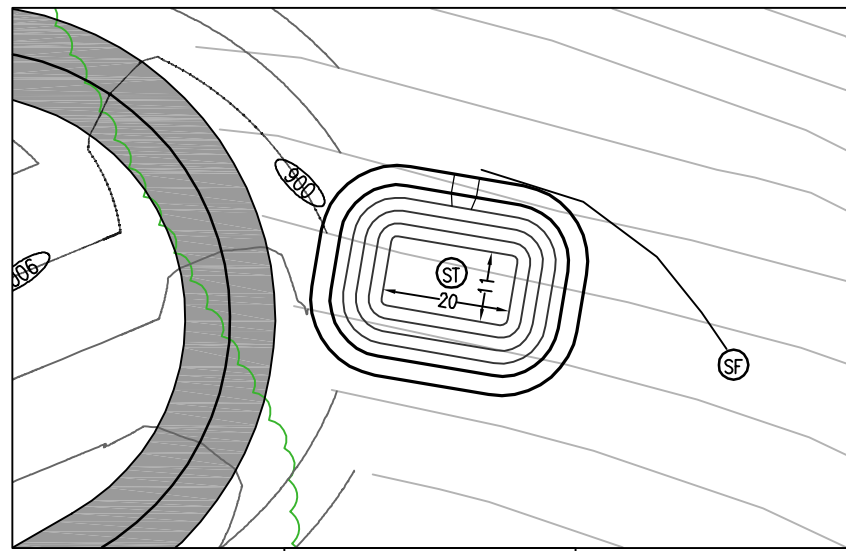

SEDIMENT TRAP "C"  
HORIZONTAL 1" = 30'

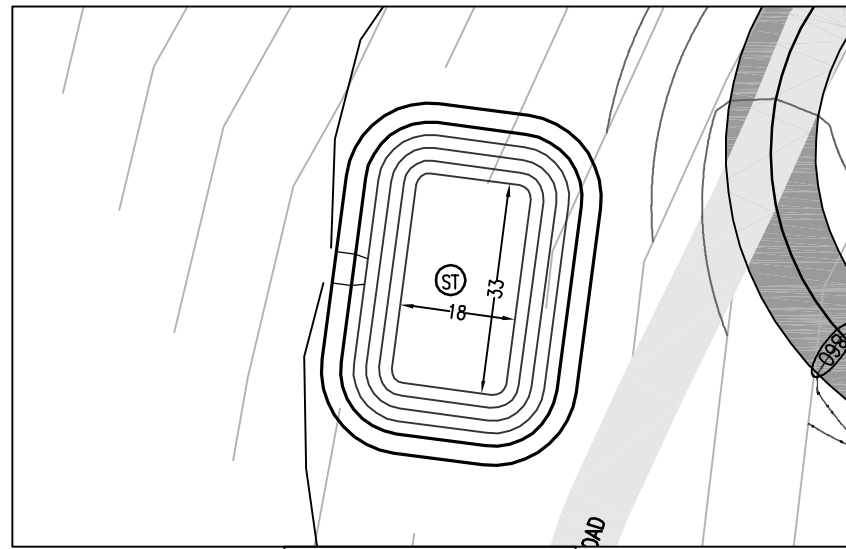

SEDIMENT TRAP "D"  
HORIZONTAL 1" = 30'

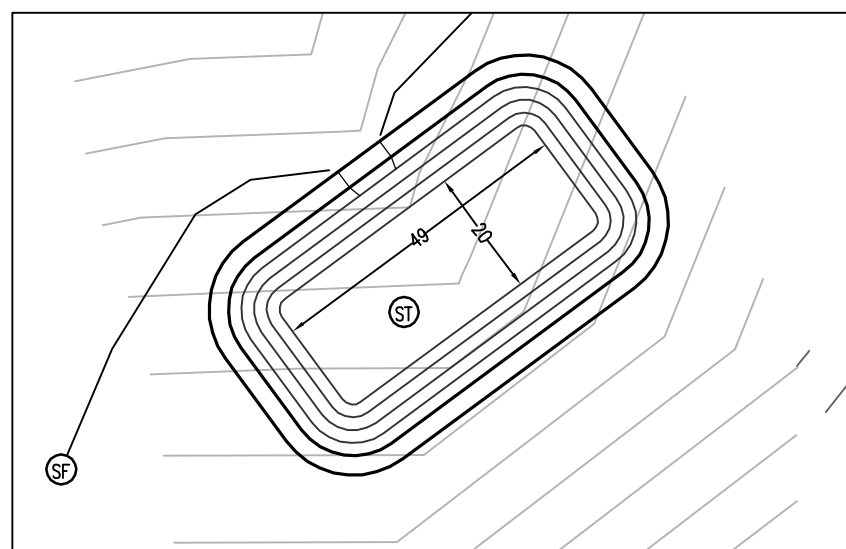

SEDIMENT TRAP "E2"  
HORIZONTAL 1" = 30'

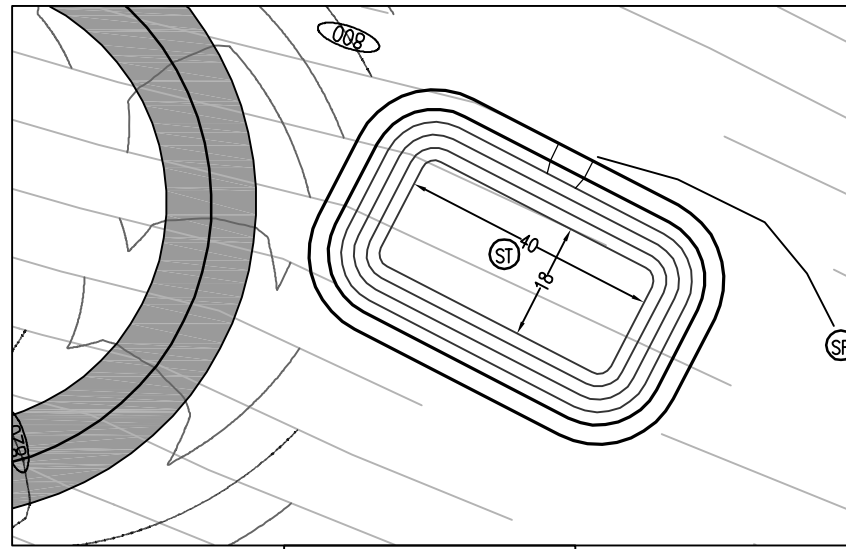

SEDIMENT TRAP "F"  
HORIZONTAL 1" = 30'

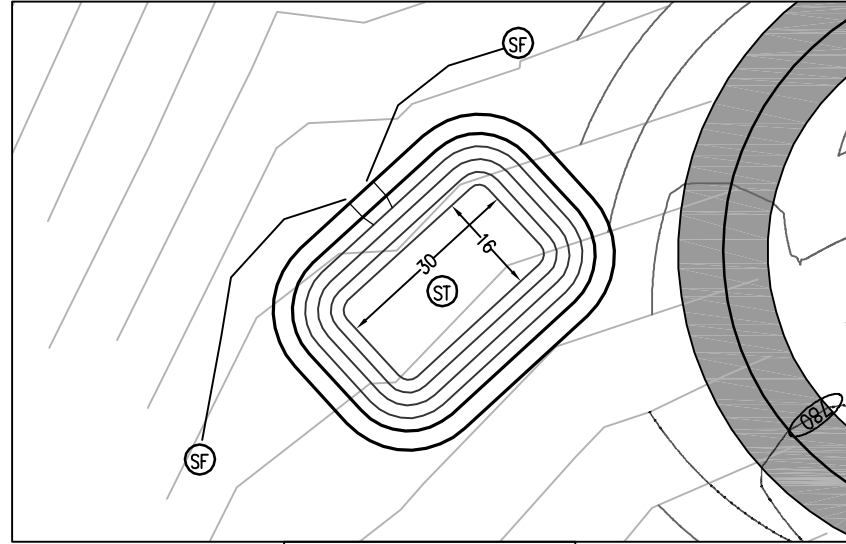

SEDIMENT TRAP "G"  
HORIZONTAL 1" = 30'

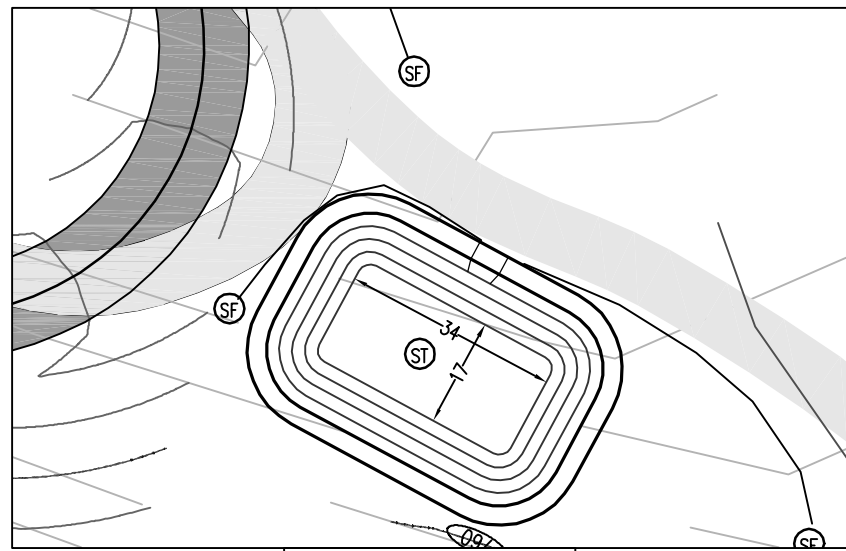

SEDIMENT TRAP "H"  
HORIZONTAL 1" = 30'

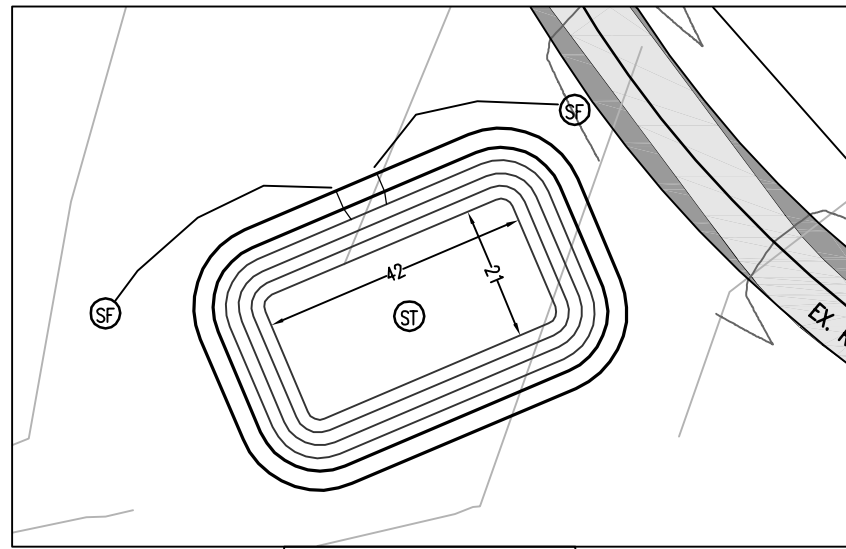

SEDIMENT TRAP "I"  
HORIZONTAL 1" = 30'

LEGEND:  
SF = 3.05 SILT FENCE  
DD = 3.09 TEMPORARY DIVERSION DIKE  
ST = 3.13 SEDIMENT TRAP

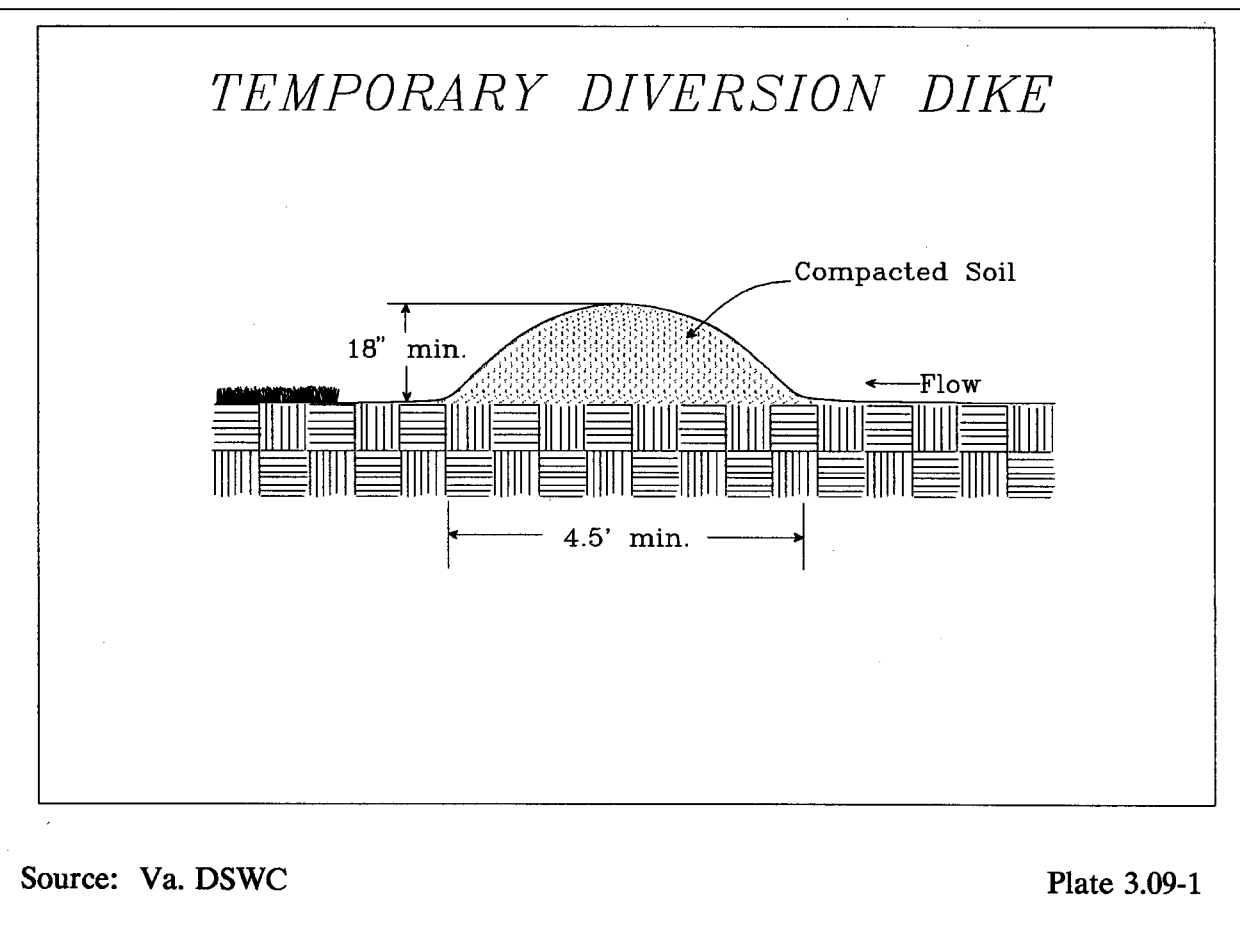
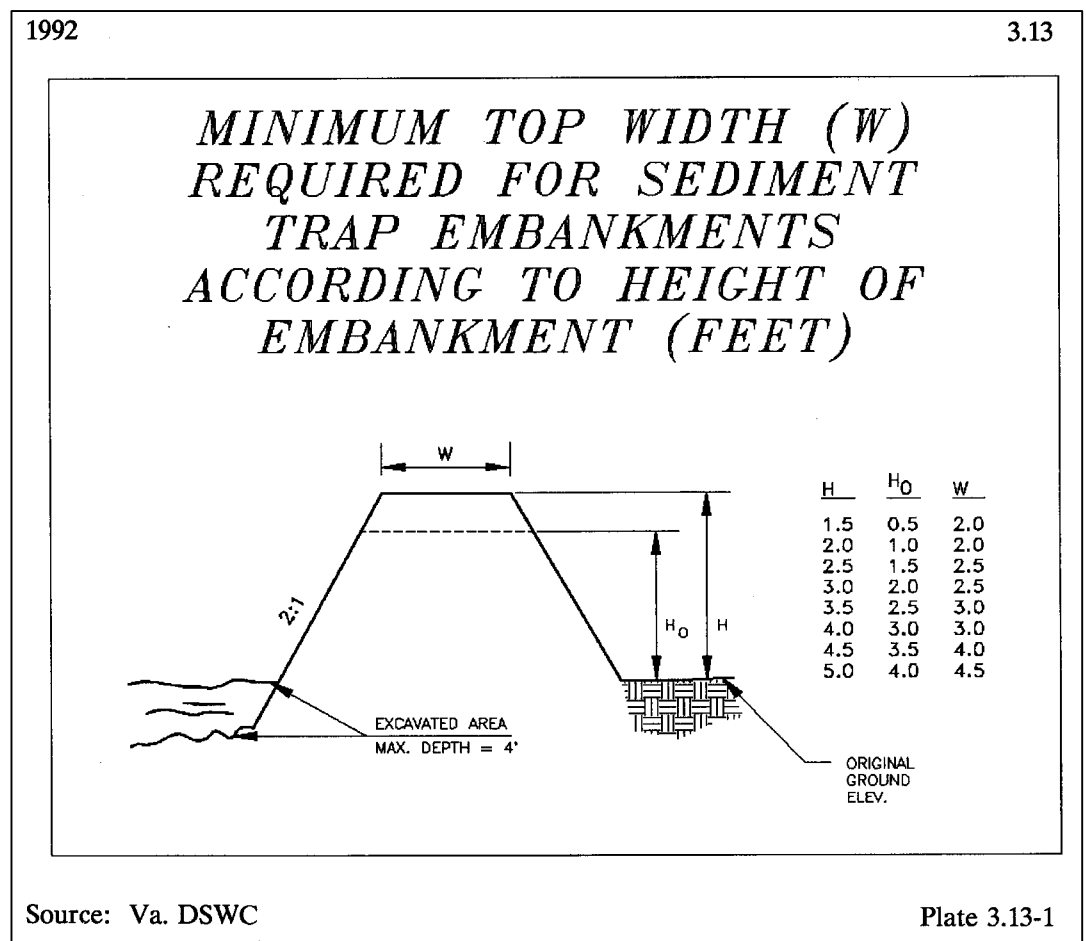
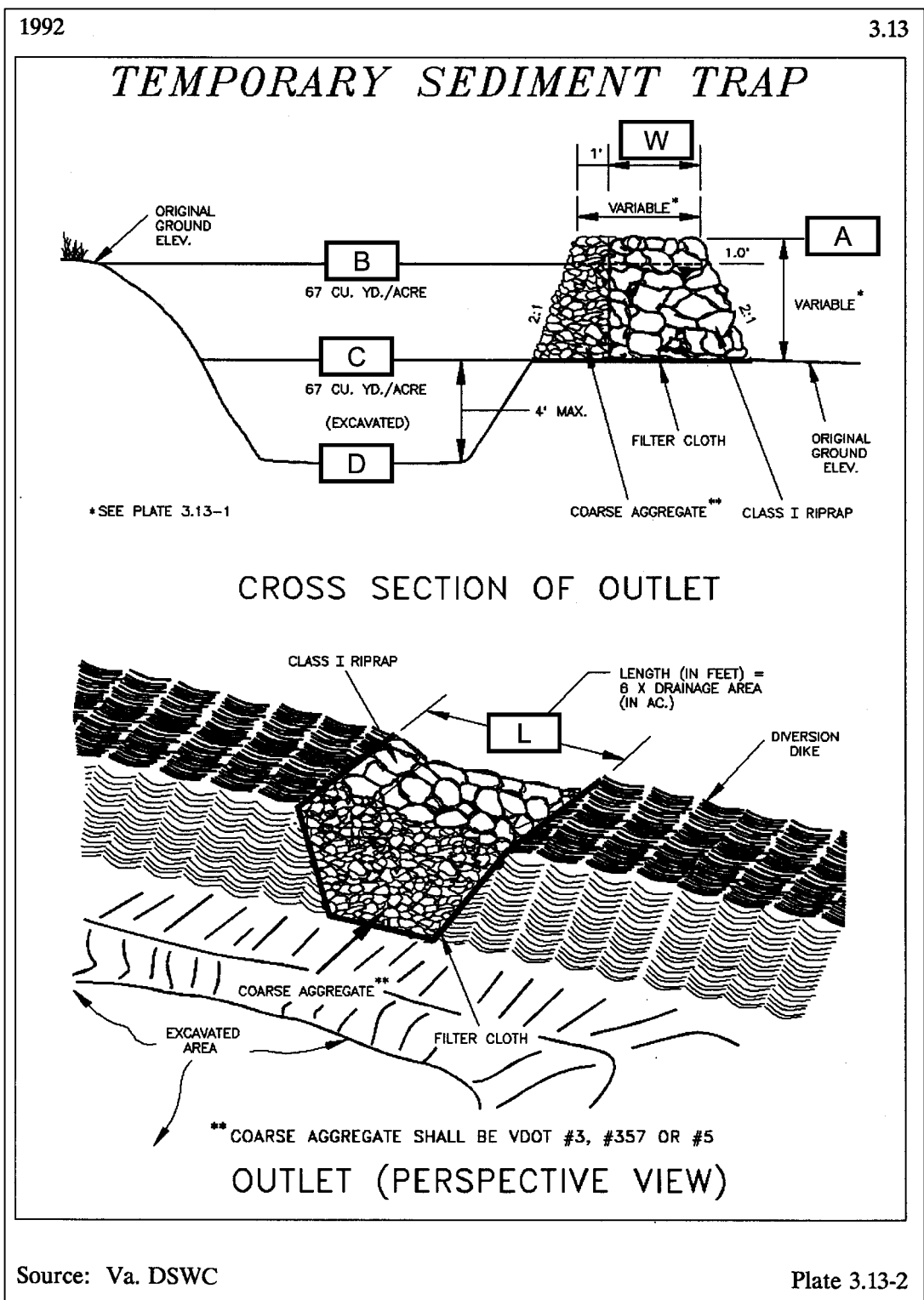
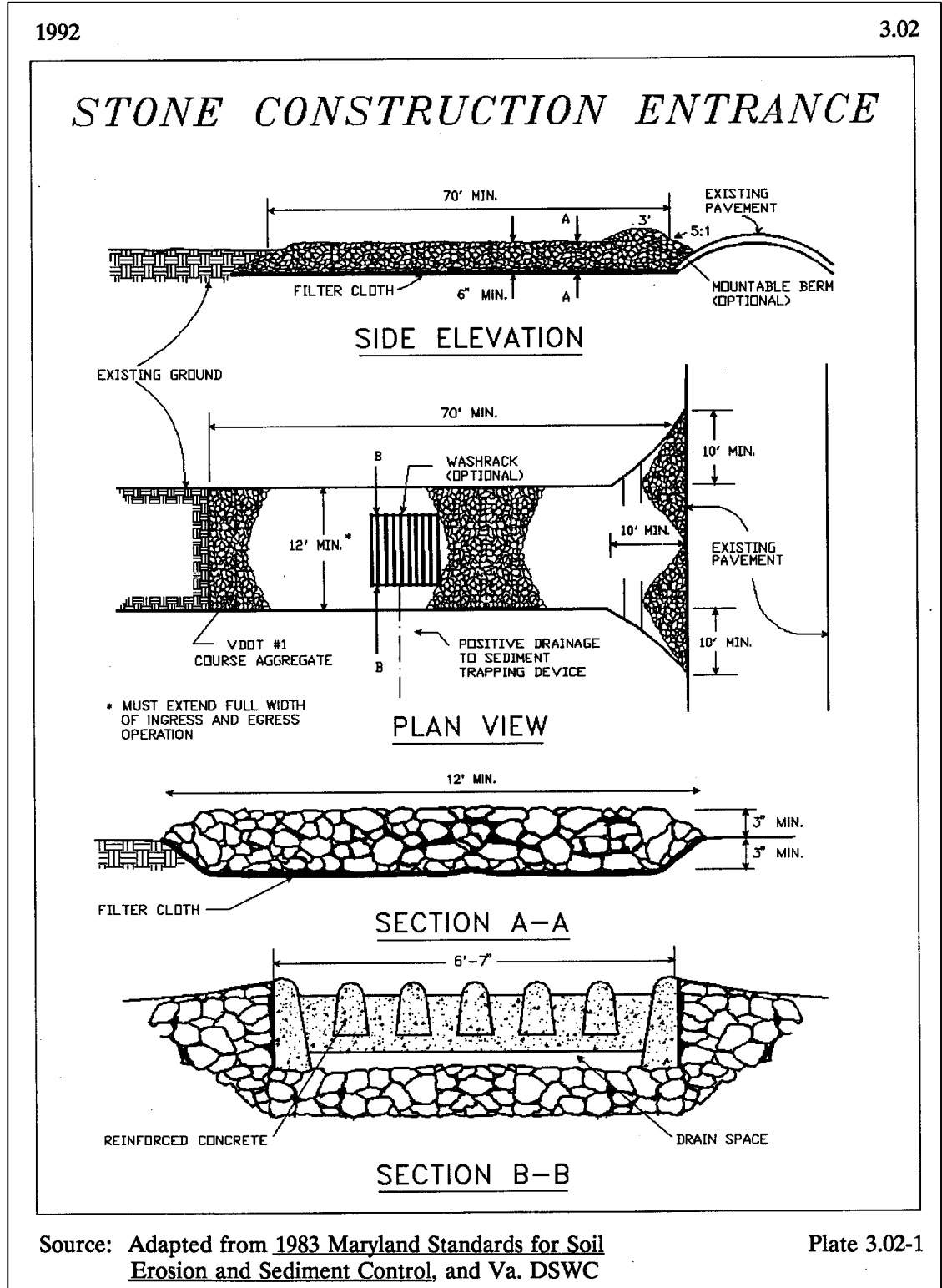
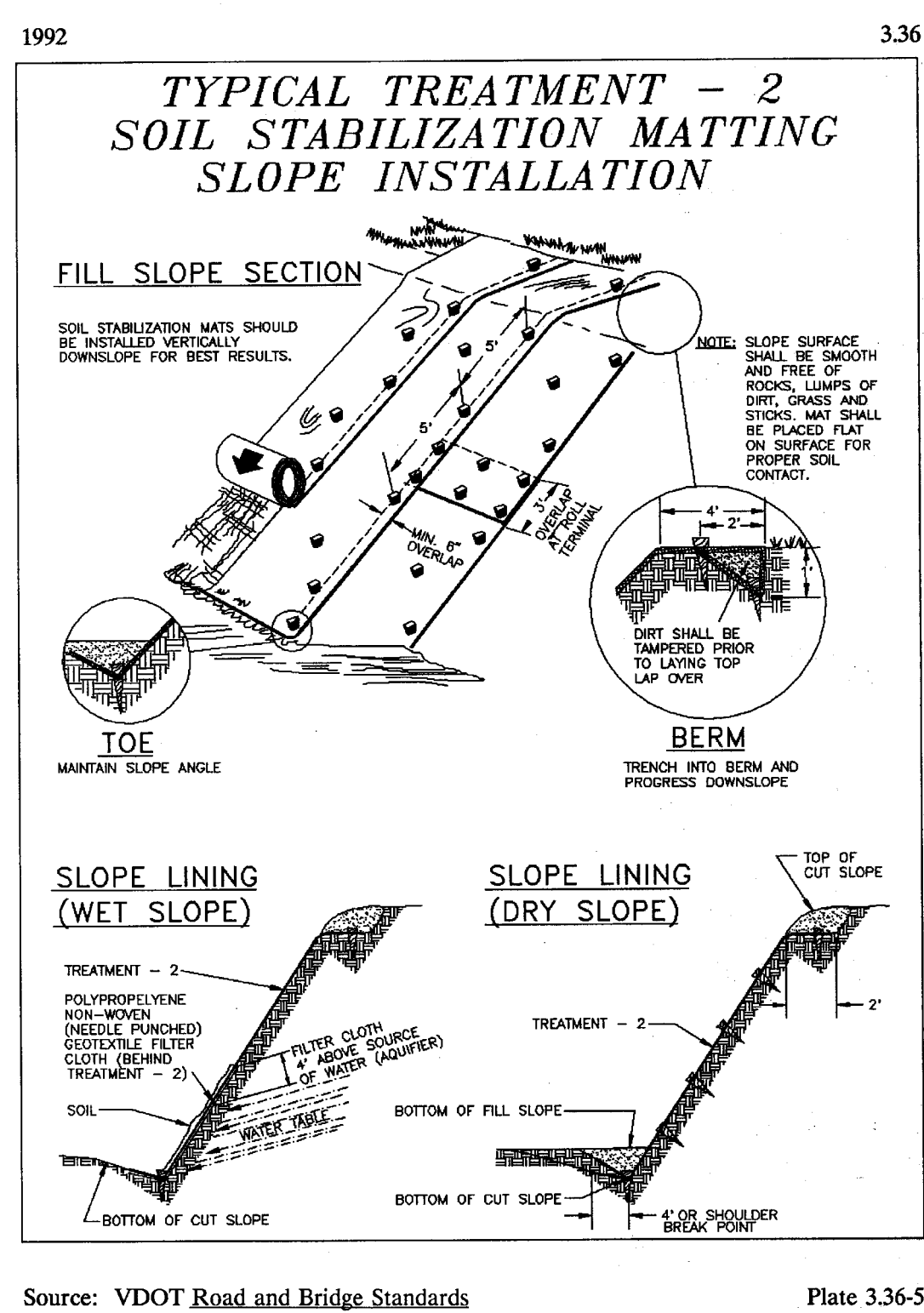
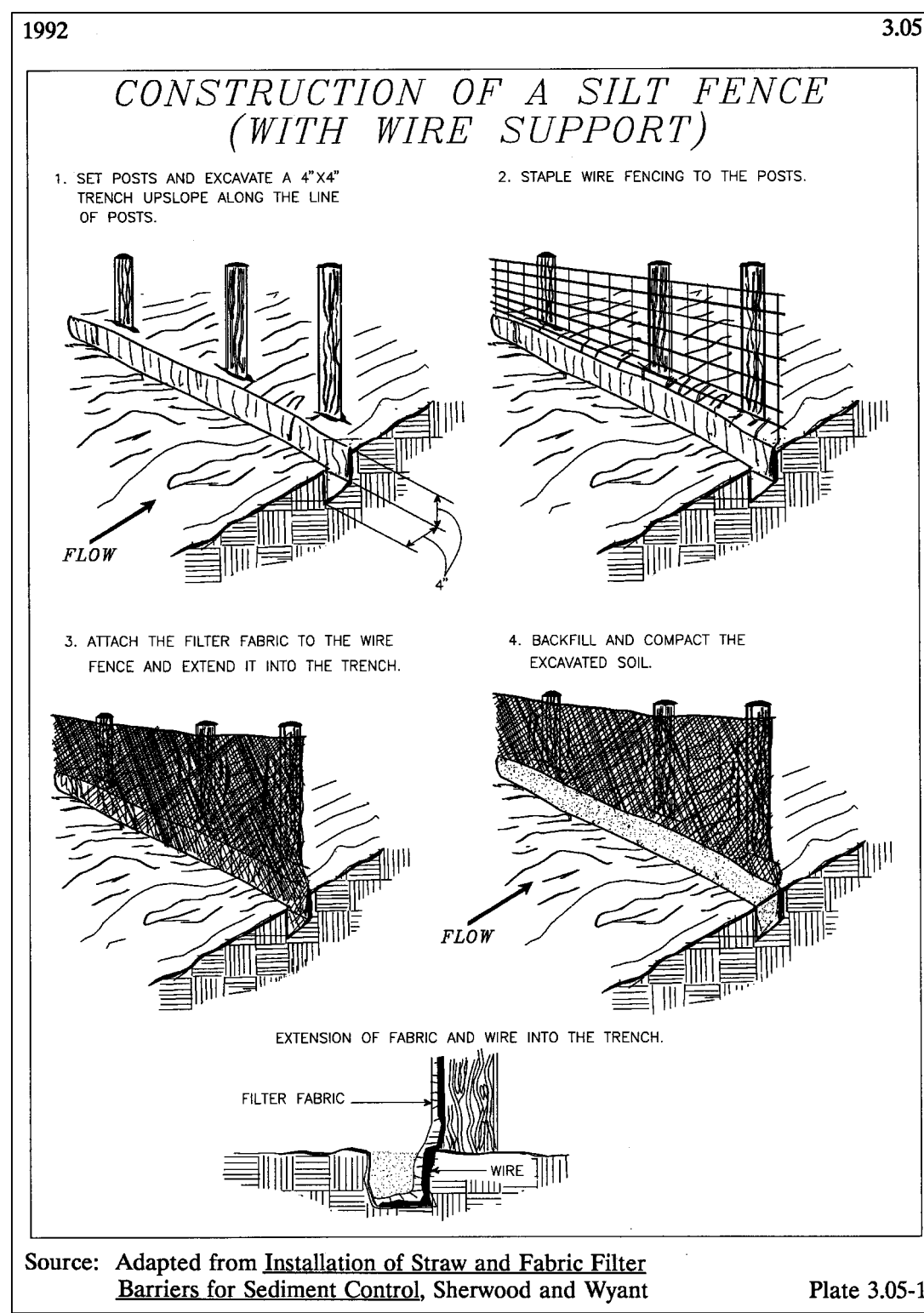

SEDIMENT TRAP SCHEDULE															
SEDIMENT TRAP NUMBER	CONTRIBUTING DRAINAGE AREA IDENTIFIER	AREA	STORAGE (CY)				TRAP DIMENSIONS AT BOTTOM OF EXCAVATION			ELEVATIONS (FT) FROM BOTTOM				BERM	
			REQUIRED		PROVIDED		WIDTH (FT)	LENGTH (FT)	DEPTH (FT)	TOP DRY STORAGE & WIER B	WET STORAGE C	EXCAVATED D			
			WET	DRY	WET	DRY							A	B	C
ST-A	A	0.30	20	20	21.1	20.1	11	20	2.0	+4.0	+3.0	+2.0	0.0	3.0	3.0
ST-B	B	1.03	69	69	69.2	69.0	20	41	2.0	+4.0	+3.0	+2.0	0.0	3.0	6.0
ST-C	C	0.3	20	20	21.4	21.4	11	20	2.0	+4.0	+3.0	+2.0	0.0	3.0	3.0
ST-D	D	0.75	50	50	51.5	50.3	18	33	2.0	+4.0	+3.0	+2.0	0.0	3.0	5.0
ST-E2	E	1.23	82	82	82.8	82.4	20	49	2.0	+4.0	+3.0	+2.0	0.0	3.0	8.0
ST-F	F	0.94	63	63	63.6	63.2	18	40	2.0	+4.0	+3.0	+2.0	0.0	3.0	6.0
ST-G	G	0.6	40	40	42.3	40.2	16	30	2.0	+4.0	+3.0	+2.0	0.0	3.0	5.0
ST-H	H	0.7	47	47	50.3	50.0	17	34	2.0	+4.0	+3.0	+2.0	0.0	3.0	5.0
ST-I	I	1.1	74	74	74.6	74.5	21	42	2.0	+4.0	+3.0	+2.0	0.0	3.0	7.0

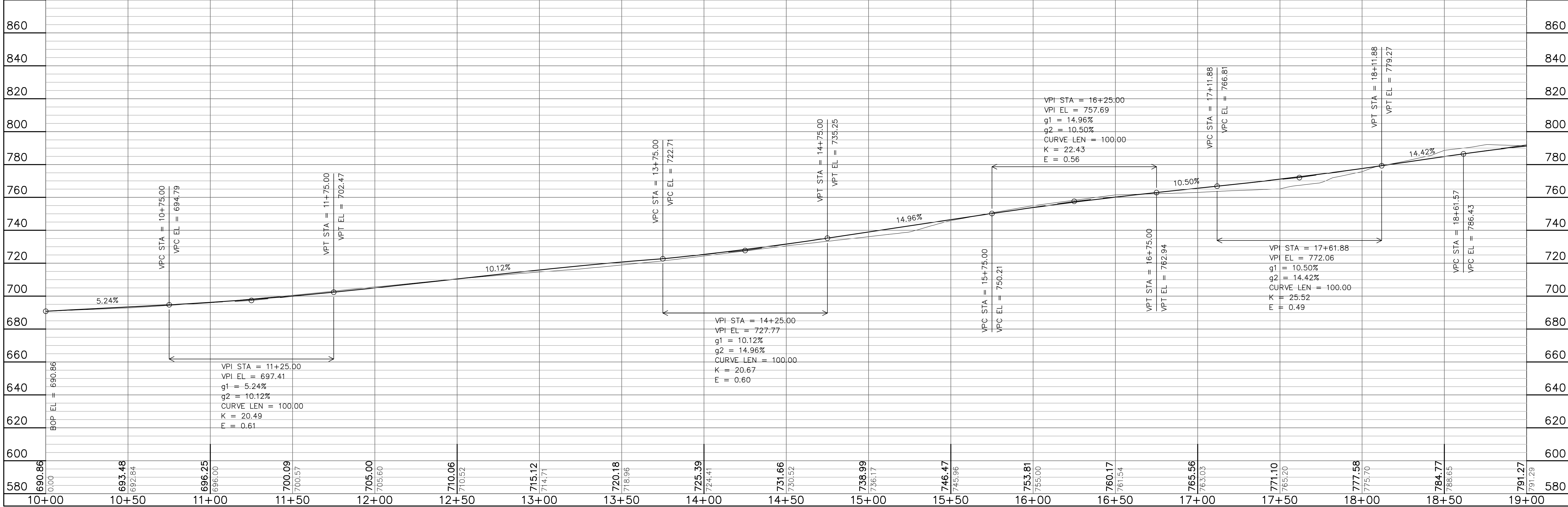
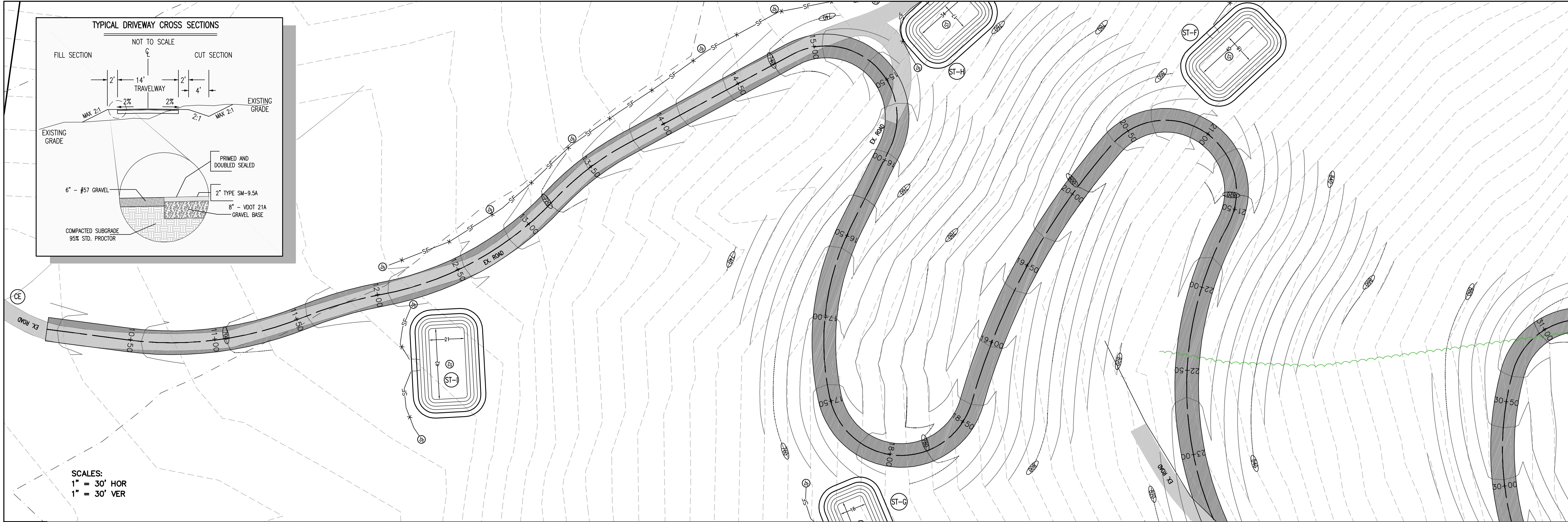

KIRK HUGHES  
&  
ASSOCIATES  
LAND SURVEYORS AND PLANNERS  
220 EAST HIGH STREET  
CHARLOTTEVILLE, VA. 22902  
(804) 296-6942

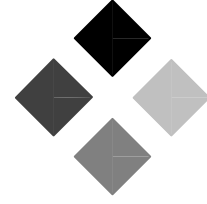

DRIVEWAY CONCEPTUAL PLAN  
TMP 06300-00-00-019E0  
LAWRENCE C., JR AND LAWRENCE C. MARSHALL  
RIVANNA MAGISTERIAL DISTRICT, ALBEMARLE COUNTY, VIRGINIA

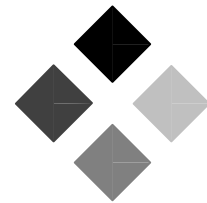

FILE NO.: 2019-013

DWG NO.: 120192019-013/2019013-01.DWG

NORTH

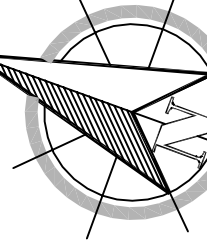

STATE SOUTH GRID  
NAD-83

DATE: MAY 24, 2019

REVISION DATES:

OCTOBER 31, 2019

SCALE: HORIZONTAL: 1" = 30'

VERTICAL: 1" = 30'

SHEET TITLE:

PLAN AND PROFILE

SHEET NO.:

3-00

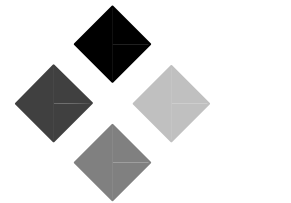
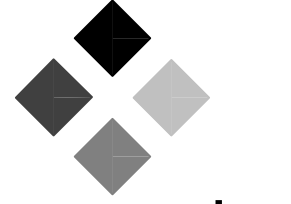
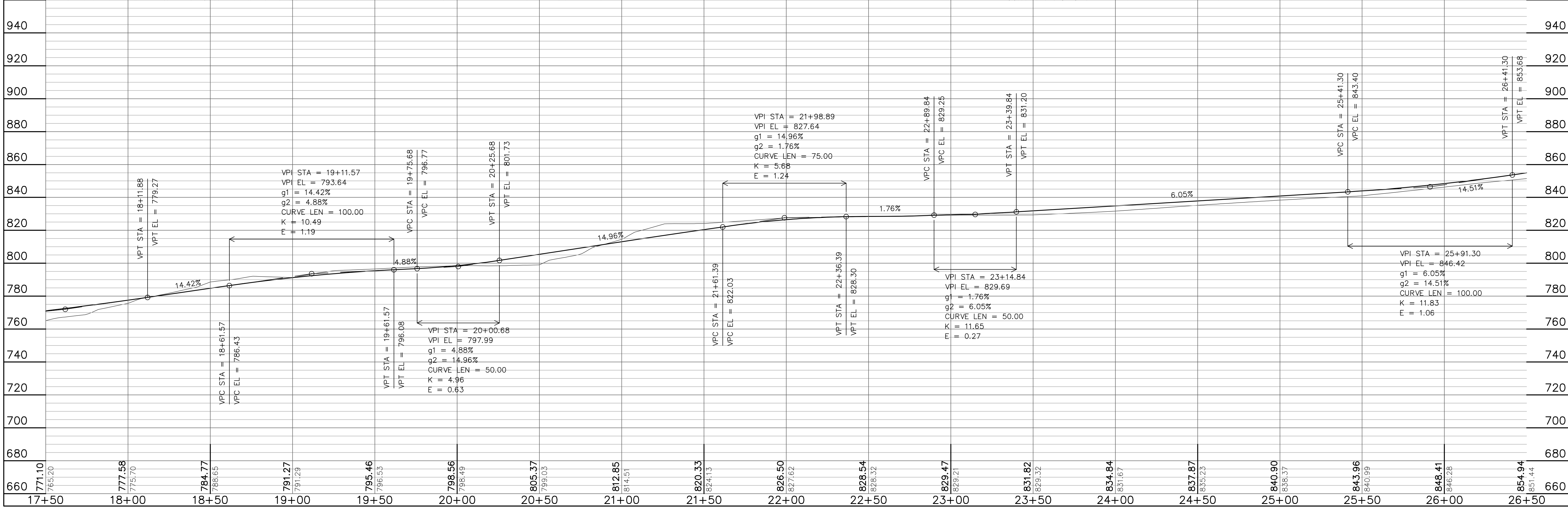
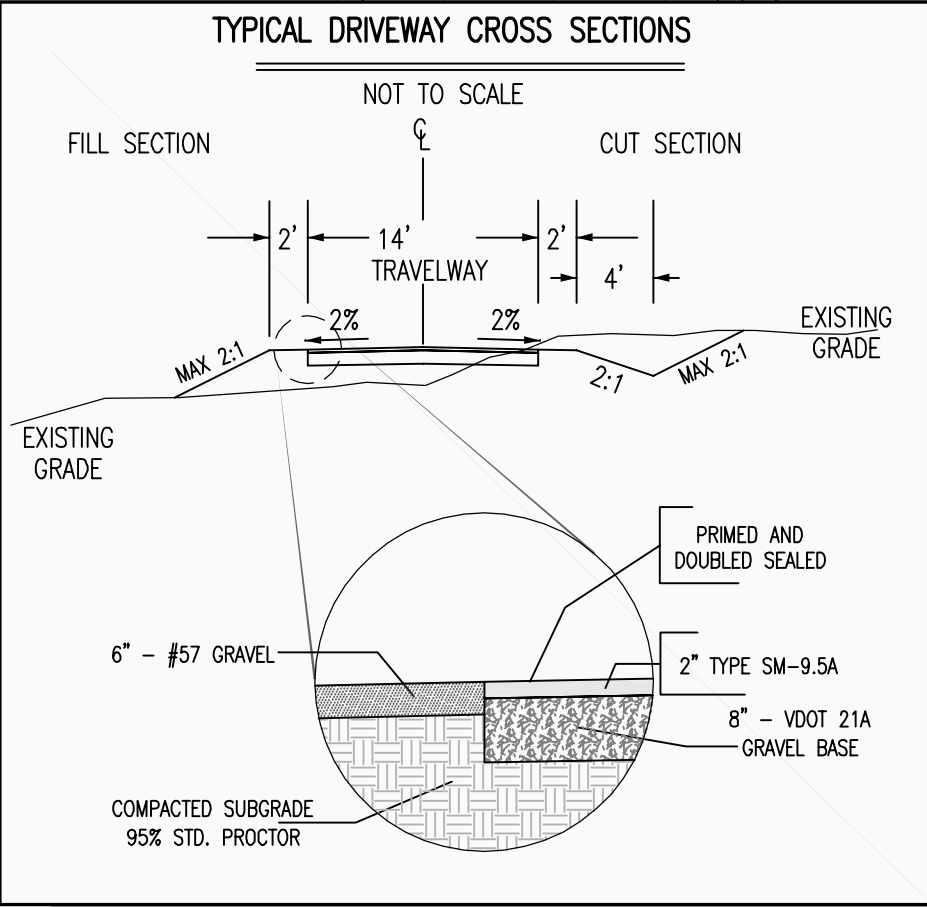
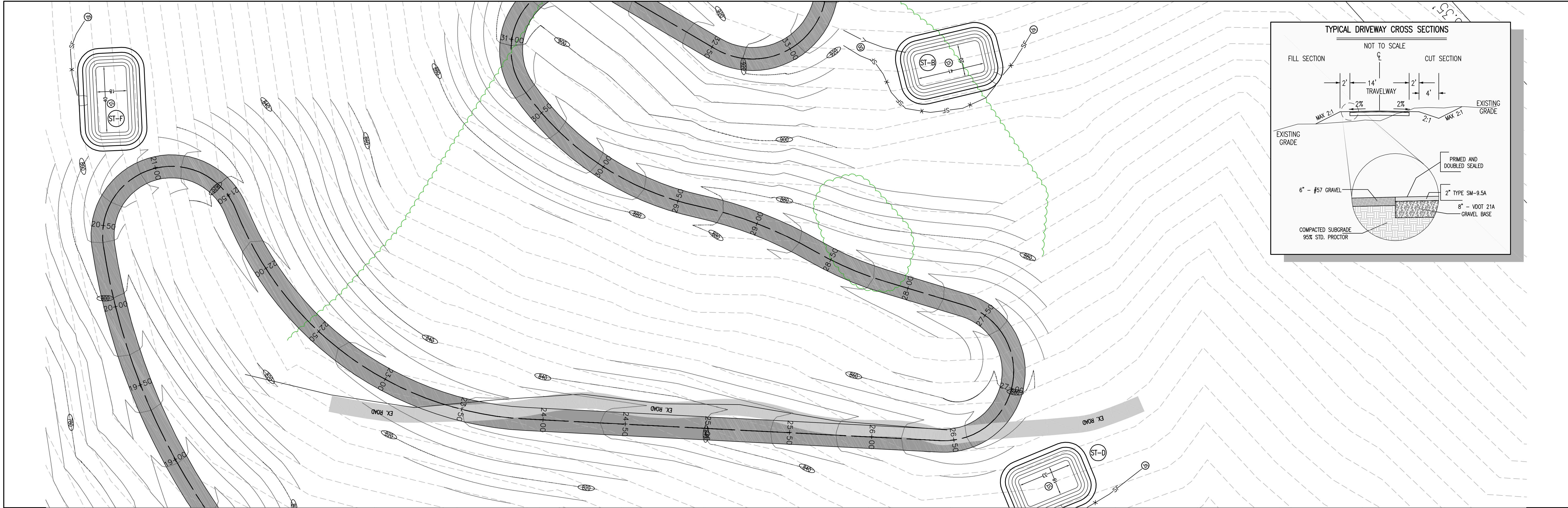

FILE NO.: 2019-013

DWG. NO.: 12019/2019-013/2019013-01.DWG

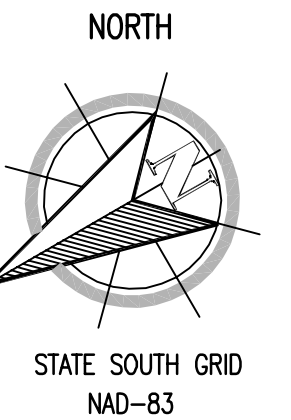

DATE: MAY 24, 2019

REVISION DATES:  
OCTOBER 31, 2019

SCALE: HORIZONTAL: 1" = 30'  
VERTICAL: 1" = 30'

SHEET TITLE:

PLAN AND PROFILE

SHEET NO.:

4-00

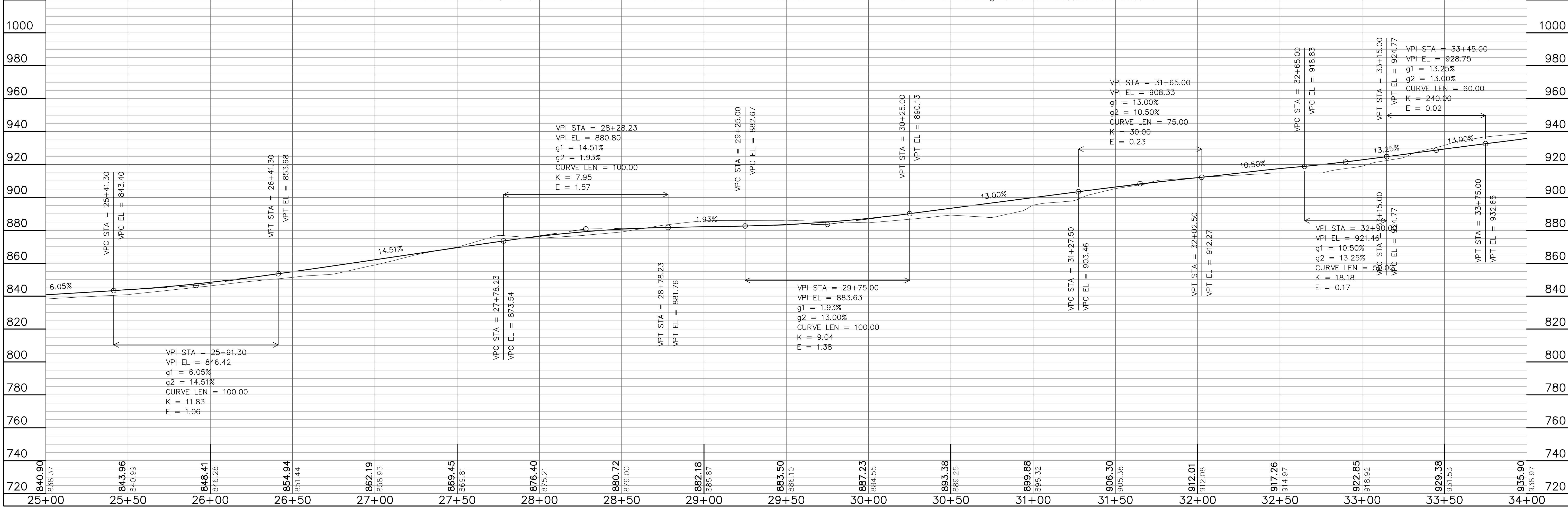
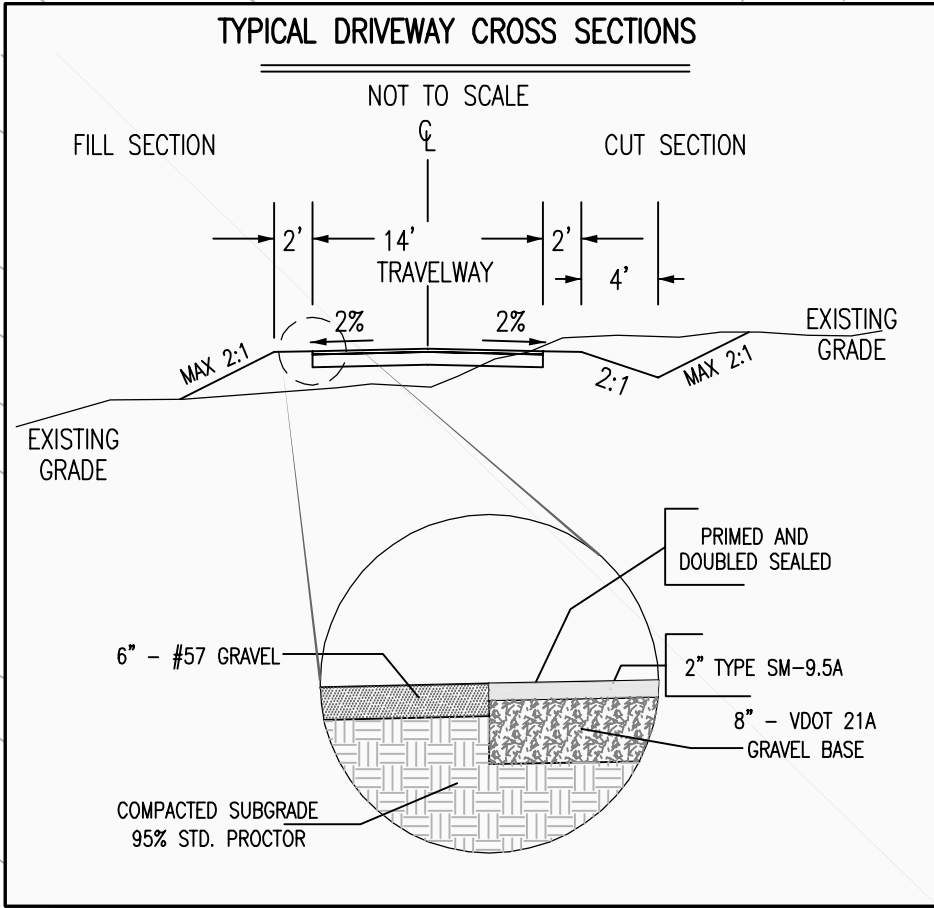
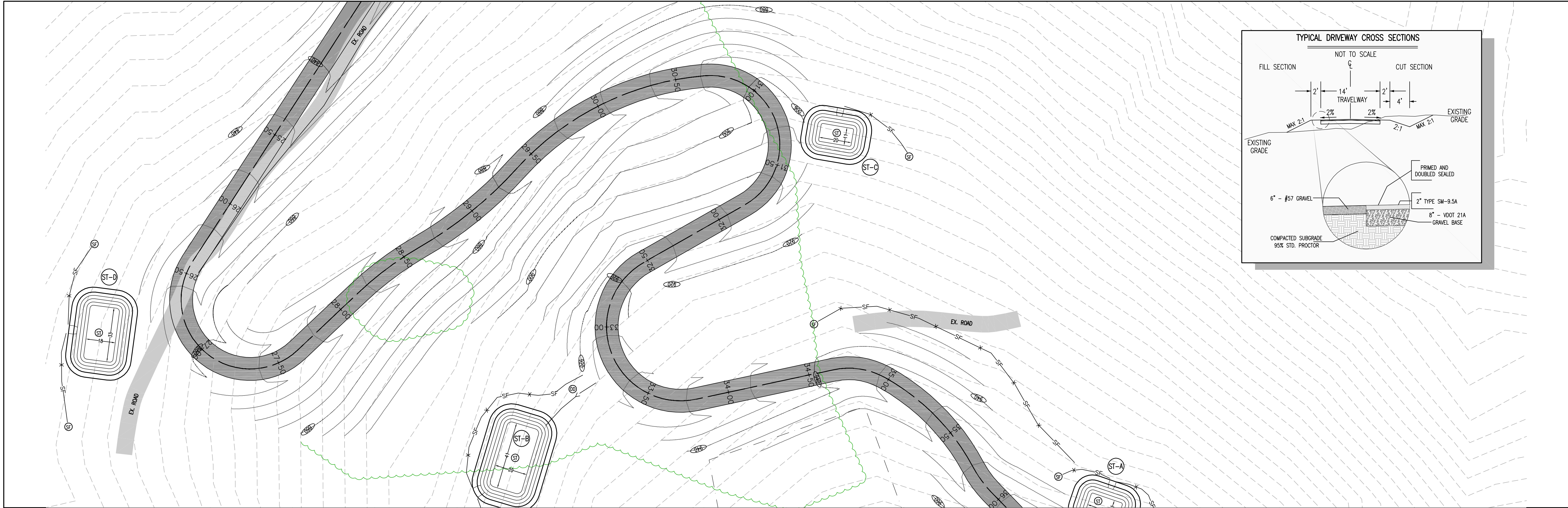

KIRK HUGHES  
&  
ASSOCIATES  
LAND SURVEYORS AND PLANNERS  
220 EAST HIGH STREET  
CHARLOTTESVILLE, VA. 22902  
(804) 296-6942

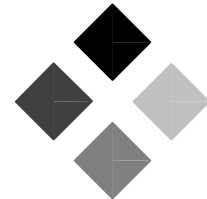

DRIVEWAY CONCEPTUAL PLAN  
TMP 06300-00-00-019E0  
LAWRENCE C., JR AND LAWRENCE C. MARSHALL  
RIVANNA MAGISTERIAL DISTRICT, ALBEMARLE COUNTY, VIRGINIA

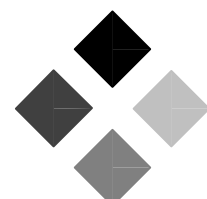

FILE NO.: 2019-013

DWG. NO.: 12019/2019-013/2019013-01.DWG

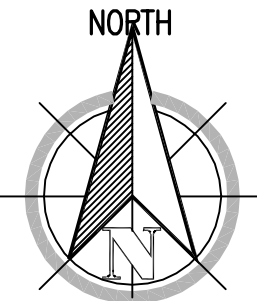

STATE SOUTH GRID  
NAD-83

DATE: MAY 24, 2019

REVISION DATES:  
OCTOBER 31, 2019

SCALE: HORIZONTAL: 1" = 30'  
VERTICAL: 1" = 30'

SHEET TITLE:

PLAN AND PROFILE

SHEET NO.:

5-00

