

LINE	BEARING	DISTANCE
L1	S06°46'09"W	73.07
L2	S71°00'00"W	55.00
L3	S54°00'00"W	90.00
L4	S23°00'00"W	55.00
L5	S20°00'00"E	95.00
L6	S40°00'00"W	55.00
L7	S10°00'00"W	60.00
L8	S24°00'00"E	145.00
L9	S17°01'00"E	125.40
L10	S33°00'00"E	170.00
L11	S44°00'00"E	120.00
L12	S13°00'00"E	70.00
L13	S29°00'00"W	100.00
L14	S51°00'00"W	105.00
L15	S35°00'00"W	200.00
L16	S81°00'00"W	30.00
L17	S32°00'00"W	135.00

SBL DENOTES SETBACK LINE

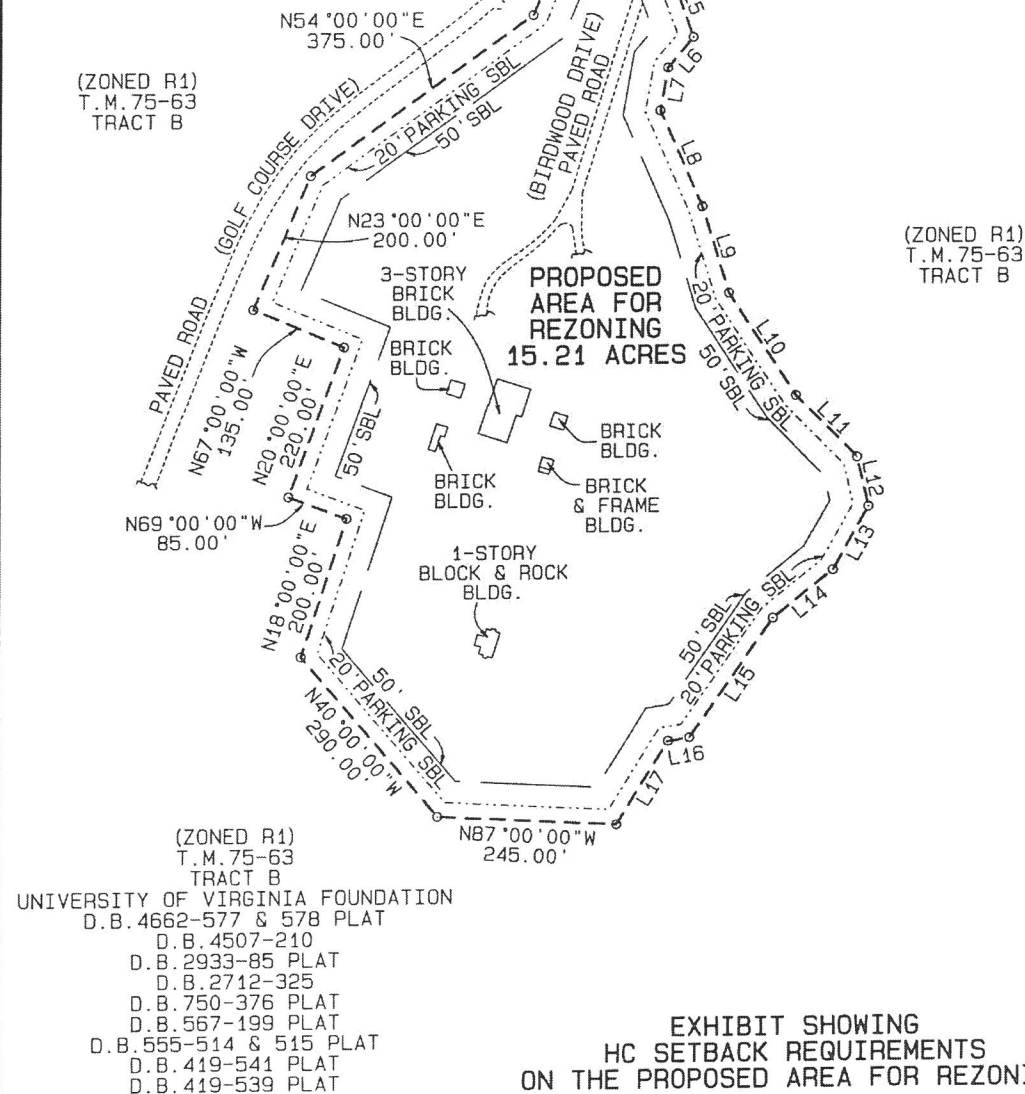

EXHIBIT SHOWING  
HC SETBACK REQUIREMENTS  
ON THE PROPOSED AREA FOR REZONING

SCALE: 1" = 200'  
DATE: OCTOBER 18, 2018  
REVISED: MARCH 11, 2019  
REVISED: MARCH 21, 2019

ROGER W. RAY & ASSOC., INC.  
663 BERKMAR COURT  
CHARLOTTESVILLE, VIRGINIA 22901  
TELEPHONE: (434) 293-3195  
RAYSURVEYING.COM

GL

14256B