

NOTES:

A DISCREPANCY EXISTS BETWEEN THE GIS DATA AND THE PROPERTY BOUNDARIES PER THE SUBDIVISION PLAT AND PREVIOUS SUP DRAWINGS. THE PLAT AND SUP DRAWINGS ARE ASSUMED AS ACCURATE. THE GIS PROPERTY LINES IN BLUE ARE STILL SHOWN FOR REFERENCE.

THE PLANTING PLAN IS CONCEPTUAL. EXISTING TREES IN THE UNDISTURBED BUFFER WILL REMAIN & BE SUPPLEMENTED BY ADDITIONAL SHADE TREES. ADDITIONAL TREES WILL BE ADDED THROUGHOUT THE PROPERTY PER COUNTY CODE REQUIREMENTS.

SITE WALLS WILL ADHERE TO STEEP SLOPE REGULATIONS. THEY WILL BE LESS THAN 6' TALL AND SPACED MORE THAN 3' APART WITH SCREENING SHRUBS PLANTED NO MORE THAN 10' APART.

RECREATIONAL FEATURES ARE T.B.D. THE GENERAL LOCATION IS INDICATED ON THE PLAN.

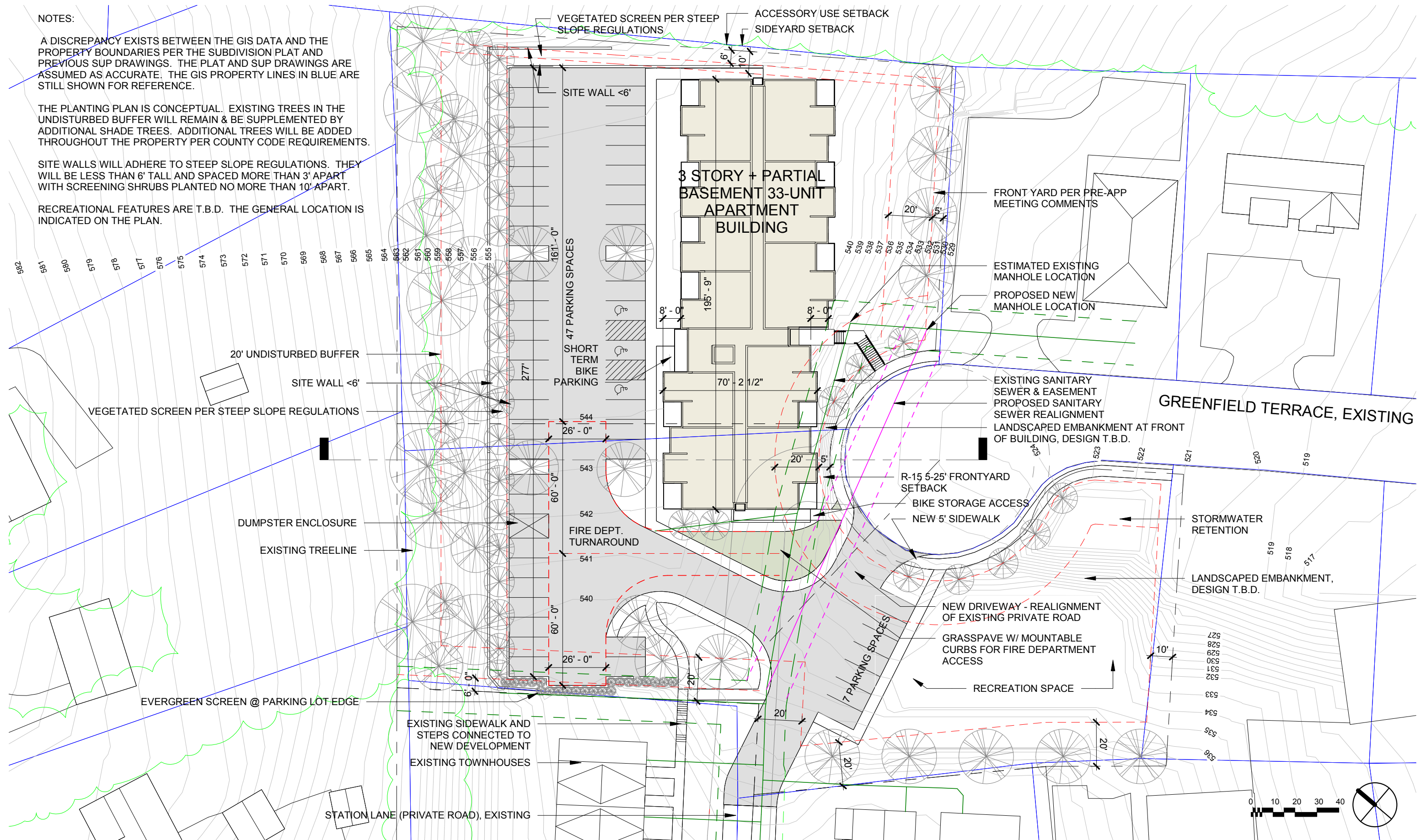

GREENFIELD TERRACE APARTMENTS

URBAN PLACES LLC
ALBEMARLE COUNTY, VA

SITE PLAN

© Powe Studio Architects PC

REVISED

7 JANUARY 2019



GREENFIELD TERRACE APARTMENTS

URBAN PLACES LLC
ALBEMARLE COUNTY, VA

SITE PLAN & GROUND FLOOR

© Powe Studio Architects PC

REVISED

7 JANUARY 2019