

November 5, 2018

Tim Padalino  
Department of Community Development  
401 McIntire Road, Room 227  
Charlottesville, VA 22902

**RE: Claudius Crozet Park Phase III Athletic Field Improvements (Lighting Plan) –  
REQUEST FOR SPECIAL EXCEPTION**

*Exception Request for modification to max height of lighting & full cutoff luminaires*

Dear Tim Padalino:

Please allow this letter to serve as our official request for (2) special exception requests for the proposed Athletic Field lighting at Claudius Crozet Park for the baseball field. The applicant would like to request a SE pursuant to the Zoning Ordinance 4.17.5(a) to waive/modify the 35' maximum structure height for outdoor athletic lighting; and a SE pursuant to the Zoning Ordinance 4.17.5(a) to waive/modify the lighting standards requiring the lighting fixtures to be full cut-off luminaires. Both modifications to the Albemarle County Zoning Ordinance Section 4.17 are allowed with a Special Exception from the Board of Supervisors. The following information is a description why that the special exception is being sought and the reason for the special exception.

The special exceptions are being proposed for the Claudius Crozet Park to provide the required lighting for an athletic (baseball) field. The proposed lighting plan illustrates the required lighting location and specifications necessary to light the athletic field for use during night skies. This lighting plan requires the positioning of the light fixtures at a height of 70' in order to light the baseball fields. The maximum allowable height for lighting fixtures in the Albemarle County Zoning Ordinance is 35', but the ordinance does allow an increase in height for athletic field lights with a special exception request. In addition, these lights will not meet dark sky requirements under the zoning ordinance, as these fixtures will not be full cut-off light fixtures. The light fixtures have been designed to light only the ballfield, thus limiting the spill-over of the lighting on the surrounding area. As illustrated in the site plan amendment, there will be no spill-over of lighting onto the adjacent properties. The lighting plan has been designed to limit the negative effects of the lighting and ensure that the measured footcandles along property line are 0.5 footcandles or less.

The proposed Athletic field lighting is for the Peachtree baseball, which operates at the Claudius Crozet Park fields. The Peachtree baseball season starts in March and runs through August each year. The organization also has fall practices between September and October. The lights would be operational during this season, from March through October each year. The lights would be used for games and practices Monday through Saturday during the baseball season. The typical hours of operation of the lighted baseball field would be until 10pm, except in the event of a tournament or weather delay where the length of the game may extend past 10pm for those circumstances.

Thank you again for the consideration of this special exception request, and please contact me if you have any questions or require any further information.

Sincerely,

Scott Collins

## Luminaire and Driver Components – TLC-BT-575

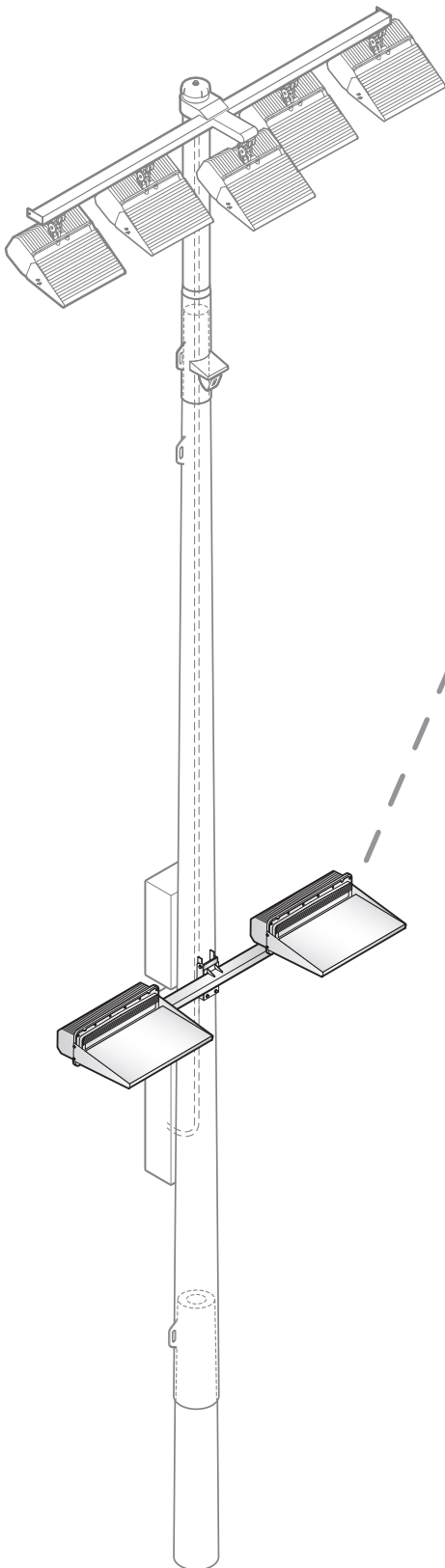

### Luminaire Data

Weight (luminaire)	34 lb (15 kg)
UL listing number	E338094
UL Listed for USA / Canada	UL1598 CSA-C22.2 No.250.0
Ingress protection, luminaire	IP65
Material and finish	Aluminum, powder-coat painted
Wind speed rating (aiming only)	150 mi/h (67 m/s)

### Photometric Characteristics

Projected lumen maintenance per IES TM-21-11

L90 (13.5k)	>81,000 h
L80 (13.5k)	>81,000 h
L70 (13.5k)	>81,000 h
CIE correlated color temperature	5700 K
Color rendering index (CRI)	75 typ, 70 min
Lumens <sup>1</sup>	52,000

Footnotes:

1) Incorporates appropriate dirt depreciation factor for life of luminaire.

All components from foundation to poletop are designed to work together in Light-Structure System™ to ensure reliable, trouble-free operation.

## Luminaire and Driver Components – TLC-BT-575

### Driver Data

#### Electrical Data

Rated wattage<sup>1</sup>

Per driver 575 W

Per luminaire 575 W

Number of luminaires per driver 1

Starting (inrush) current <40 A, 256 µs

Fuse rating 15 A

UL, IEC ambient temperature rating, electrical components enclosure 50°C (122°F)

Ingress protection, electrical components enclosure IP54

Efficiency 95%

### Typical Wiring

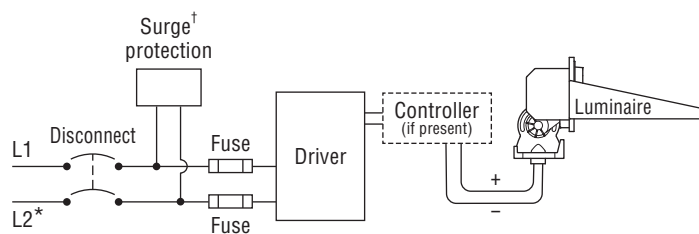

\* If L2 (com) is neutral then not switched or fused.

† Not present if indoor installation.

	200 Vac 50/60 Hz	208 Vac 60 Hz	220 Vac 50/60 Hz	230 Vac 50 Hz	240 Vac 50/60 Hz	277 Vac 60 Hz	347 Vac 60 Hz	380 Vac 50/60 Hz	400 Vac 50 Hz	415 Vac 50 Hz	480 Vac 60 Hz
<b>Max operating current<sup>2</sup> per luminaire</b>	3.48 A	3.35 A	3.16 A	3.03 A	2.90 A	2.51 A	2.01 A	1.83 A	1.74 A	1.68 A	1.45 A

#### Footnotes:

- 1) Rated wattage is the power consumption, including driver efficiency losses, at stabilized operation in 25°C ambient temperature environment.
- 2) Operating current includes allowance for 0.90 minimum power factor, operating temperature, and LED light source manufacturing tolerances.

#### Notes

1. Use thermal magnetic HID-rated or D-curve circuit breakers.
2. See *Musco Control System Summary* for circuit information.

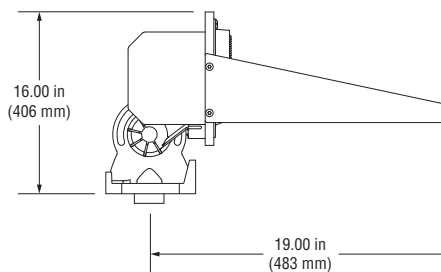
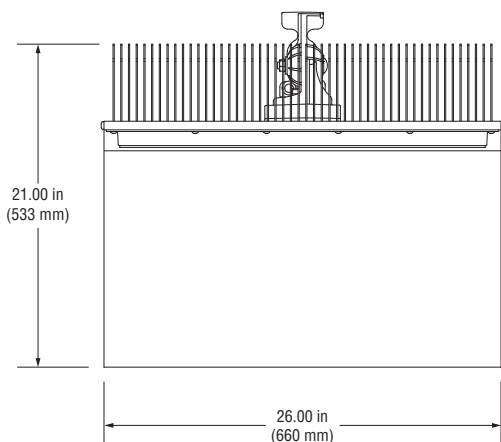

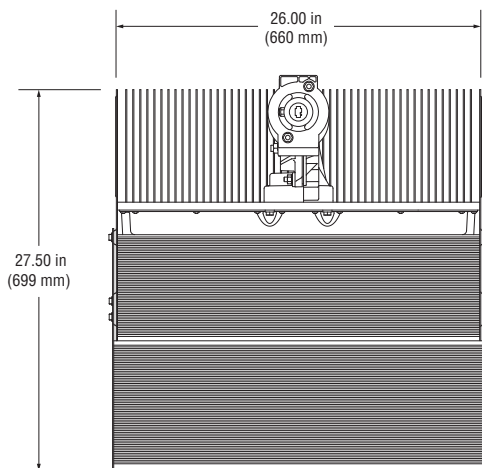
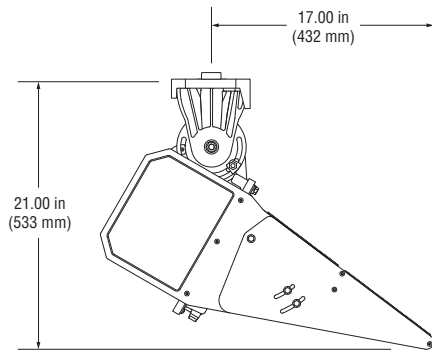
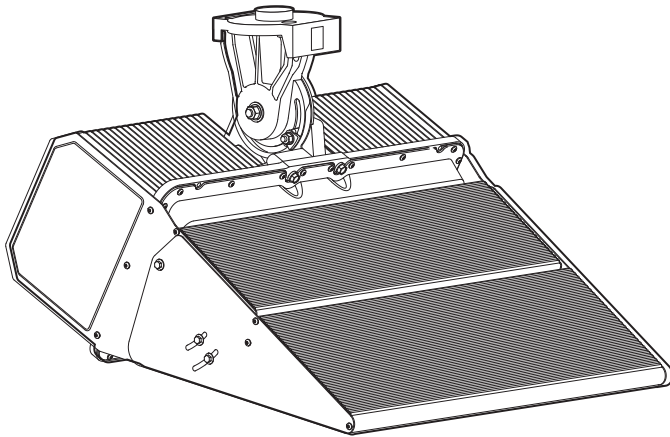

## Luminaire Data

Weight (luminaire)	80 lb (36 kg)
UL listing number	E338094
UL listed for USA / Canada	UL1598 CSA-C22.2 No.250.0
Ingress protection, luminaire	IP65
Material and finish	Aluminum, powder-coat painted
Wind speed rating (aiming only)	150 mi/h (67 m/s)
UL ambient temperature rating, luminaire	50°C (122°F)

## Photometric Characteristics

Projected lumen maintenance per IES TM-21-11

L90 (13.5k)	>81,000 h
L80 (13.5k)	>81,000 h
L70 (13.5k)	>81,000 h
CIE correlated color temperature	5700 K
Color rendering index (CRI)	75 typ, 70 min
Lumens <sup>1</sup>	121,000

Footnotes:

1) Incorporates appropriate dirt depreciation factor for life of luminaire.

## Driver Data

## Typical Wiring

### Electrical Data

Rated wattage <sup>1</sup>	
Per driver	1150 W
Per luminaire	1150 W
Number of luminaires per driver	1
Starting (inrush) current	<40 A, 256 $\mu$ s
Fuse rating	15 A
UL, IEC ambient temperature rating, electrical components enclosure	50°C (122°F)
Ingress protection, electrical components enclosure	IP54
Efficiency	95%
Dimming mode	optional
Range, energy consumption	20 – 100%
Range, light output	25 – 100%

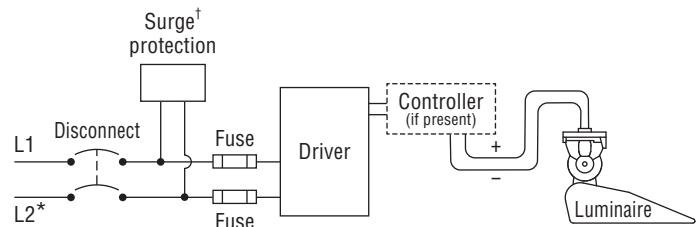

\* If L2 (com) is neutral then not switched or fused.

† Not present if indoor installation.

	200 Vac 50/60 Hz	208 Vac 60 Hz	220 Vac 50/60 Hz	230 Vac 50 Hz	240 Vac 50/60 Hz	277 Vac 60 Hz	347 Vac 60 Hz	380 Vac 50/60 Hz	400 Vac 50 Hz	415 Vac 50 Hz	480 Vac 60 Hz
Max operating current per luminaire <sup>2</sup>	7.11 A	6.83 A	6.46 A	6.18 A	5.92 A	5.13 A	4.10 A	3.74 A	3.56 A	3.43 A	2.96 A

### Footnotes:

- 1) Rated wattage is the power consumption, including driver efficiency losses, at stabilized operation in 25°C ambient temperature environment.
- 2) Operating current includes allowance for 0.90 minimum power factor, operating temperature, and LED light source manufacturing tolerances.

### Notes

1. Use thermal magnetic HID-rated or D-curve circuit breakers.
2. See *Musco Control System Summary* for circuit information.



**COUNTY OF ALBEMARLE****APPLICATION FOR A SPECIAL EXCEPTION**

- ☒ Request for a waiver, modification, variation or substitution permitted by Chapter 18 = **\$457**
- ☐ Variation to a previously approved Planned Development rezoning application plan or Code of Development = **\$457**

OR

- ☐ Relief from a condition of approval = **\$457**

**Provide the following**

- ☒ 3 copies of a written request specifying the section or sections being requested to be waived, modified, varied or substituted, and any other exhibit documents stating the reasons for the request and addressing the applicable findings of the section authorized to be waived, modified, varied or substituted.

**Provide the following**

- ☐ 3 copies of the existing approved plan illustrating the area where the change is requested or the applicable section(s) or the Code of Development. Provide a graphic representation of the requested change.
- ☐ 1 copy of a written request specifying the provision of the plan, code or standard for which the variation is sought, and state the reason for the requested variation.

**Project Name :** Crozet Park Phase III Athletic Field Improvements - Minor Site Plan Amendment

**Current Assigned Application Number (SDP, SP or ZMA)** SDP2018-00077

**Tax map and parcel(s):** 056A2-01-00-072A0

**Applicant / Contact Person** Collins Engineering

**Address** 200 Garrett Street, Suite K **City** Charlottesville **State** VA **Zip** 22902

**Daytime Phone#** (434) 293-3719 **Fax#** ( ) **Email** scott@collins-engineering.com

**Owner of Record** Claudius Crozet Park Inc

**Address** PO Box 171 **City** Crozet **State** VA **Zip** 22932

**Daytime Phone#** ( ) **Fax#** ( ) **Email**



# COUNTY OF ALBEMARLE

## APPLICATION FOR A SPECIAL EXCEPTION

### APPLICATION SIGNATURE PAGES

#### VERIFICATION OF THE SIGNATURE ON THE NEXT PAGE MUST HAPPEN BEFORE THE APPLICATION MAY BE DEEMED COMPLETE

If ownership of the property is in the name of any type of legal entity or organization including, but not limited to, an LLC, a corporation, a partnership or association, or a trust, then a document acceptable to the County must be submitted with this application certifying that the person signing has the authority to do so.

If the applicant is a contract purchaser, a document acceptable to the County must be submitted containing the owner's written consent to the application and must include any applicable documents authorizing that person to provide consent.

If the applicant is the agent of the owner, a document acceptable to the County must be submitted that is evidence of the existence and scope of the agency. Please attach the owner's written consent.

#### One (1) copy of the applicable ownership information.

CHECK AS APPLICABLE	OWNERSHIP OF THE PROPERTY IS A	DOCUMENT TO BE PROVIDED FOR THIS APPLICATION
<input type="checkbox"/>	Limited liability company ("LLC")	The articles of organization and when the power is delegated to someone other than a manager or a member, also the operating agreement.
<input type="checkbox"/>	Stock & Nonstock corporation	
<input type="checkbox"/>	for a board of directors	Stock - the articles of incorporation or a shareholders agreement may limit the board's statutory authority.  Nonstock - the articles of incorporation and the by-laws, the latter of which may include a member or director agreement, may limit the board's statutory authority
<input type="checkbox"/>	for a person expressly authorized by the board of directors	written evidence of that authorization such as a board resolution or board minutes
<input type="checkbox"/>	for a committee	an action of the board of directors authorizing the committee to act; the articles of incorporation or the by-laws may limit the statutory authority
<input type="checkbox"/>	for a corporate officer	the by-laws or the delegating resolution of the board of directors.
<input type="checkbox"/>	Partnership	The statement of partnership authority, which may limit the authority of one or more partners.
<input type="checkbox"/>	Limited partnership	The partnership agreement, or amendments thereto, which may limit the authority of one or more general partners.
<input checked="" type="checkbox"/>	Incorporated & Unincorporated church and other religious body	(1) for trustees, an authorizing court order (2) for the corporation holding title, the appropriate corporate documents (2) for a bishop, minister or ecclesiastical officer, the laws, rules or ecclesiastical polity of the entity that authorizes the person to hold, improve, mortgage, sell and convey the property.
<input type="checkbox"/>	Land trust	The deed of conveyance to the trustees and the trust instrument

See Attachment A in the Land Use Law Handbook for a complete list of Authorized Signatories for Land Use Applications

**COUNTY OF ALBEMARLE****APPLICATION FOR A SPECIAL EXCEPTION****Owner/Applicant Must Read and Sign**

I hereby certify that I own the subject property, or have the legal power to act on behalf of the owner in filing this application. I also certify that the information provided on this application and accompanying information is accurate, true, and correct to the best of my knowledge. By signing this application I am consenting to written comments, letters and or notifications regarding this application being provided to me or my designated contact via fax and or email. This consent does not preclude such written communication from also being sent via first class mail.

Matthew L. Sposato  
Signature of Owner/Agent or Contract Purchaser

11/6/18  
Date

Matthew L. Sposato  
Print Name

434.242.6999  
Daytime phone number of Signatory

Crozet Park Board, Vice President

RECEIVED  
NOV 07 2018  
COMMUNITY  
DEVELOPMENT

Fee Received

914.00

Received Date

11/7/18

Received By

me

FOR OFFICE USE ONLY

APPLICATION#

SDP2018-77

Fee Amount \$

914.00

Date Paid

11/9/18

By who?

Peachtree Baseball  
League

Receipt #

115550

Ck#

3002

By

JS