

**RESOLUTION TO ALLOW THE DESIGN AND CONSTRUCTION OF PEDESTRIAN
CROSSING IMPROVEMENTS ON US-250E AT THE INTERSECTION WITH STATE
FARM BOULEVARD**

WHEREAS, the County of Albemarle has constructed sidewalk and ADA ramps on the southwest corner of the State Farm Boulevard/US-250E intersection as part of a VDOT Revenue Sharing project (UPC-102886) and the construction contract is nearing completion; and

WHEREAS, the County approved a site development plan for Chick-fil-A on the north side of the State Farm Boulevard/US-250E intersection where pedestrian improvements including ADA ramps, painted crosswalk, traffic signal modifications and pedestrian signal heads were constructed from the northeast to northwest corners of the intersection; and

WHEREAS, VDOT and County Staff are concerned that the combination of these intersection improvements will promote pedestrians to cross US-250E at this signalized intersection; and

WHEREAS, VDOT supports the expansion of the Revenue Sharing project (UPC-102886) to include proposed pedestrian crossing improvements on US-250E shown on the Luxor Road Plan attached hereto as a change order to the current construction contract; and

WHEREAS, the project budget for Revenue Sharing project (UPC-102886) is adequate to fund the design and construction of the proposed pedestrian crossing improvements;

NOW, THEREFORE, BE IT RESOLVED, that the Board of Supervisors of Albemarle County authorizes expansion of the project scope of Revenue Sharing project (UPC-102886) to allow the design and construction of pedestrian crossing improvements on US-250E at the intersection with State Farm Boulevard shown on the Luxor Road Plan, within the limits of the project budget.

I, Claudette Borgersen, do hereby certify that the foregoing writing is a true and correct copy of a Resolution duly adopted by the Board of Supervisors of Albemarle County by a vote of _____ to _____, as recorded below, at a meeting held on November 9, 2016.

Clerk, Board of County Supervisors

	<u>Aye</u>	<u>Nay</u>
Mr. Dill	_____	_____
Ms. Mallek	_____	_____
Ms. McKeel	_____	_____
Ms. Palmer	_____	_____
Mr. Randolph	_____	_____
Mr. Sheffield	_____	_____

REQUIRED FILL BETWEEN STATIONS 11+95.74 AND 12+79.99, AS WELL AS THE FILL BETWEEN STATIONS 13+27.37 AND 13+46.19 IS ANTICIPATED TO EXCEED 5'. SEE LUXOR ROAD SECTIONS AT STATIONS 12+20, 12+40, 12+70, AND 13+40 (THIS SHEET).

NOTE:
FOR 'ALBEMARLE COUNTY
CONSTRUCTION NOTES
C-5.1.

STEEP SLOPE
33% AND
LOW MAINTENANCE
(GROUND COVER)
MOWING

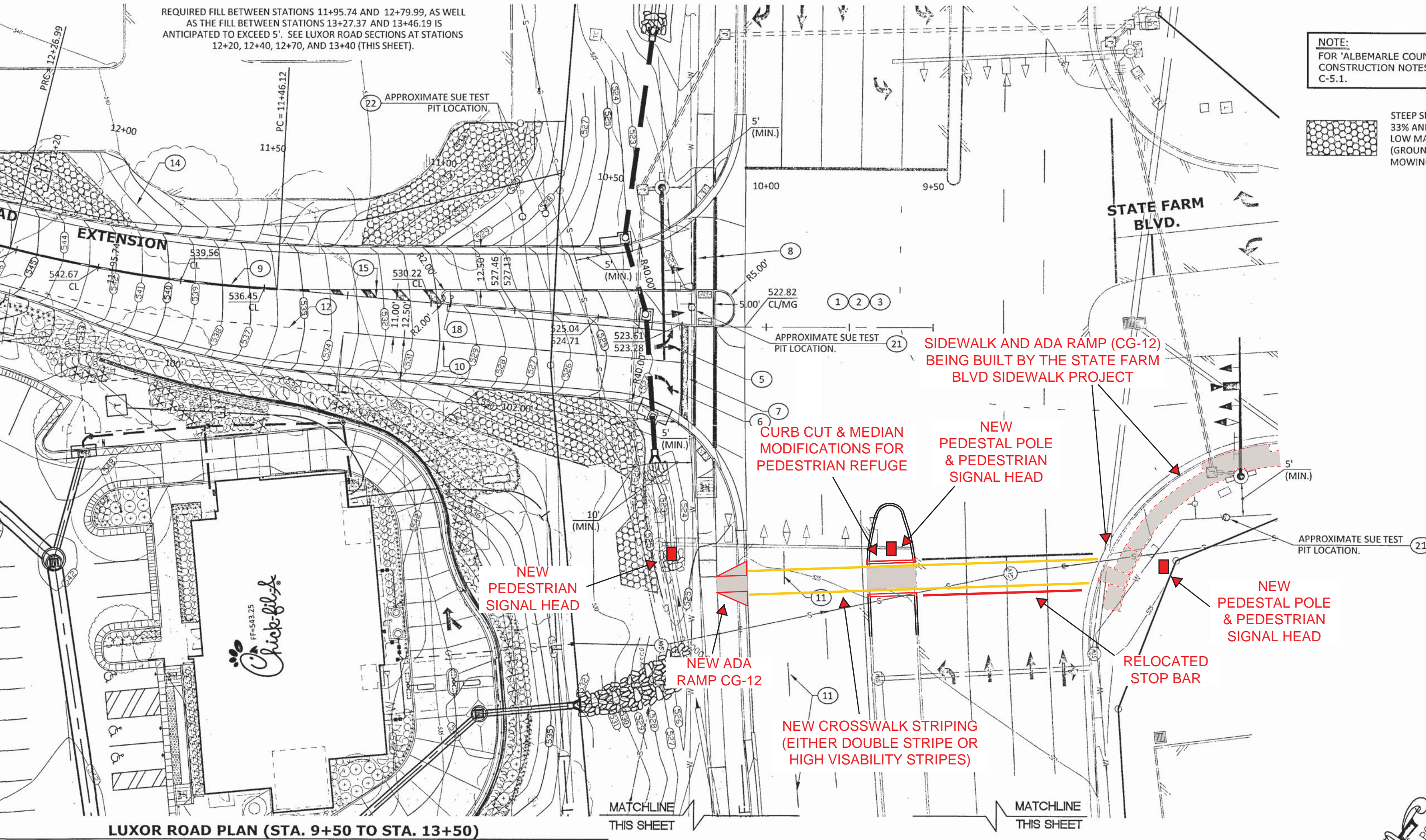

LUXOR ROAD PLAN (STA. 9+50 TO STA. 13+50)

SCALE: 1"=25'

D.B. 1138, P.