

Application to Amend the Service Authority Jurisdictional Area



Amend the Service Authority Jurisdictional Area = \$135.20 (\$130.00 + \$5.20 Technology Surcharge)

Project Name: Farmington Country Club - Tennis & Fitness Building

Tax map and parcel: TM 60E, Parcel 2-1 Magisterial District: Jack Jouett Zoning: RA

Physical Street Address (if assigned): 1625 Country Club Circle, Charlottesville, VA 22901

Location of property (landmarks, intersections, or other): _____

Contact Person (Who should we call/write concerning this project?): WW Associates, Attn: John Beirne, P.E.

Address 968 Olympia Dr., Suite 1 City Charlottesville State VA Zip 22911

Daytime Phone () (434) 984-2700 Fax # () (434) 978-1444 E-mail jbeirne@wwassociates.net

Owner of Record Farmington Country Club, Attn: Joe Krenn, COO/GM

Address 1625 Country Club Circle City 625 Country Club Circle State VA Zip 22901

Daytime Phone () (434) 245-0699 Fax # () _____ E-mail joe.krenn@farmingtoncc.com

Applicant (Who is the Contact person representing?): Farmington Country Club, Attn: Joe Krenn, COO/GM

Address 625 Country Club Circle City 625 Country Club Circle State VA Zip 22901

Daytime Phone () (434) 245-0699 Fax # () _____ E-mail joe.krenn@farmingtoncc.com

FOR OFFICE USE ONLY

TMP # _____

Fee Amount \$ _____ Date Paid _____ By who? _____ Receipt # _____ Ck# _____ By: _____

County of Albemarle Department of Community Development
401 McIntire Road Charlottesville, VA 22902 Voice: (434) 296-5832 Fax: (434) 972-4126

Jurisdiction area designation requested

- Water and Sewer
- Water Only to existing structure(s)
- Water Only
- Limited Service (Describe in justification below)

Current Service Area Designation

- No designation
- Water and Sewer
- Water Only to existing structure(s)
- Water Only
- Limited Service (Please describe _____)

Justification for request:

We are requesting sanitary sewer service for the new laundry & maintenance building location and lightning shelter as shown on the plans entitled Farmington Country Club - Tennis & Fitness Building. The proposed locations for the facilities is in the water only service area for ACSA. The existing laundry & maintenance building is currently served by both public water and sewer. Sewer service is provided via a connection to a private sanitary sewer located on Farmington property that drains to a sanitary pump station. The sanitary sewer is discharged from the pump station to a force main. The force main discharges to the public sewer system at the intersection of Old Garth Rd. and Rt. 250.

We are proposing to connect to the on-site private sanitary sewer upstream of the connection point with the publicly maintained sanitary sewer. As stated the existing laundry and maintenance building is currently served by this system. No increase in flows are anticipated with the relocated facility. In addition, the adjacent indoor tennis facility and ground maintenance buildings are served by the on-site private sanitary system. Both facilities are located within the water only ACSA jurisdictional area.

These facilities are located within the drinking water watershed for Ivy Creek. The construction of a septic tank and associated drain field has the potential for ground and surface water contamination within the drinking water watershed in the event of failure or improper construction. Surface waters can be contaminated with pathogens, such as E. coli, chemicals, and nutrients including nitrogen and phosphorus. Freshwater rivers, lakes, and ponds are particularly sensitive to phosphorus contamination from failing or improperly constructed septic systems. Connecting to the on-site sanitary sewer will allow for the sanitary effluent to be treated at the sewage treatment facility and help to prevent any potential impacts to the drinking water watershed.

Owner/Applicant Must Read and Sign

I hereby certify that the information provided on this application and accompanying information is accurate, true and correct to the best of my knowledge and belief.



Signature of Owner, Contract Purchaser, Agent

10-13-23

Date

John Beirne, P.E.

Print Name

(434) 984-2700

Daytime phone number of Signatory

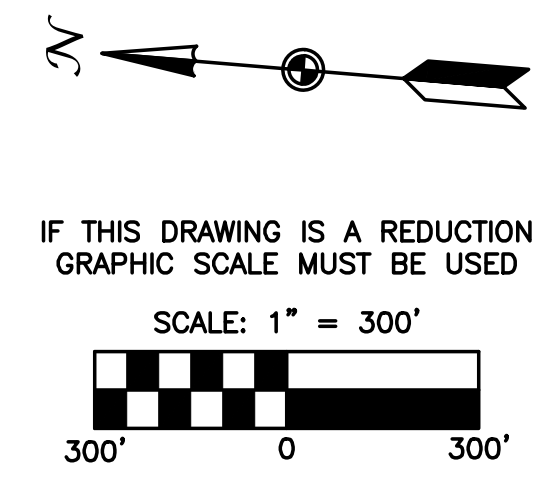
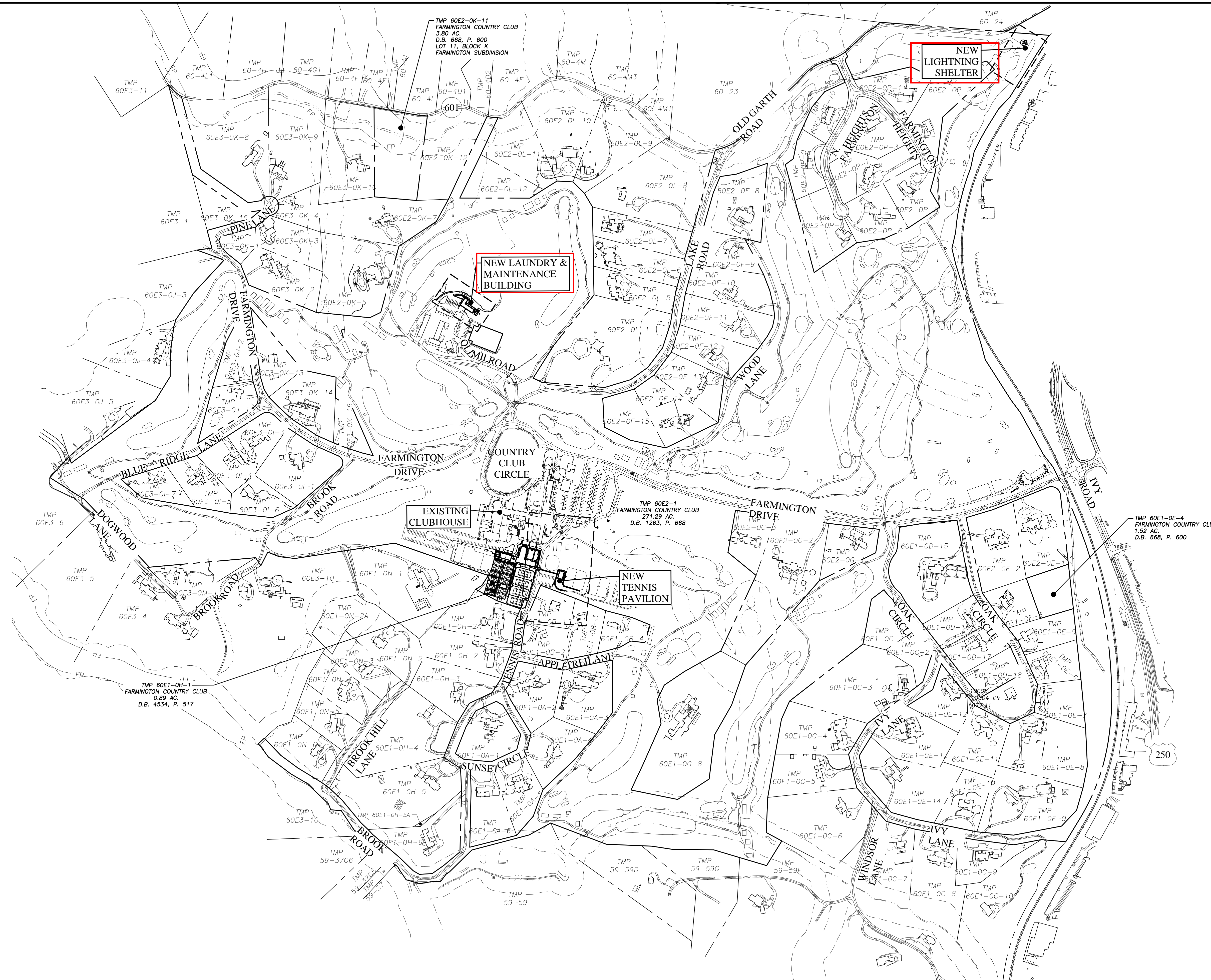

M:\222004 FCC - Tennis and Fitness Building\FCC ACSA Exhibit.dwg

1	ADDRESSED COUNTY COMMENTS	JDB	10/13/23									DESIGNED BY: JDB	PROJECT: FARMINGTON COUNTRY CLUB TENNIS AND FITNESS BUILDING ALBEMARLE COUNTY, VIRGINIA	SET REV. NO. 1
												DRAWN BY: KTM	TITLE: OVERALL SITE MAP	DRAWING NUMBER: EXHIBIT
												DIHR BY: HFW	FILE NAME: FCC ACSA Exhibit.dwg	DISCIPLINE: CIVIL
												WVA NUMBER: 222004.00	SCALE: H: 1"=300' V: N/A	DATE: 6/01/23
NO.	SHEET REVISION	BY	DATE	NO.	SHEET REVISION	BY	DATE							

