

**NOTES**

1. THE PROPERTY IS IDENTIFIED BY PARCEL IDENTIFICATION NUMBER (PID) 04600-00-00-005A0.
2. NO TITLE REPORT FURNISHED. THIS PLAT IS SUBJECT TO ANY EASEMENTS AND RESTRICTIONS OF RECORD.
3. BOUNDARY INFORMATION SHOWN HEREON IS COMPILED FROM VARIOUS SOURCES THAT MAY INCLUDE RECORD DATA AND FIELD OBSERVATION. THIS PLAT IS NOT INTENDED TO REPRESENT A BOUNDARY SURVEY.

CURVE TABLE						
CURVE	RADIUS	ARC LENGTH	TANGENT	CHORD LENGTH	CHORD BEARING	DELTA ANGLE
C1	206.14'	62.23'	31.35'	62.00'	S60°35'45"E	17°17'50"
C2	64.05'	34.26'	17.55'	33.85'	S59°16'01"E	30°38'56"
C3	37.11'	39.71'	21.99'	37.84'	S61°30'39"E	61°18'34"
C4	93.59'	105.18'	58.93'	99.73'	N85°05'39"E	64°23'35"
C5	65.00'	49.87'	26.24'	48.66'	S52°36'36"E	43°57'46"
C6	50.00'	96.41'	72.04'	82.15'	S85°52'03"E	110°28'40"

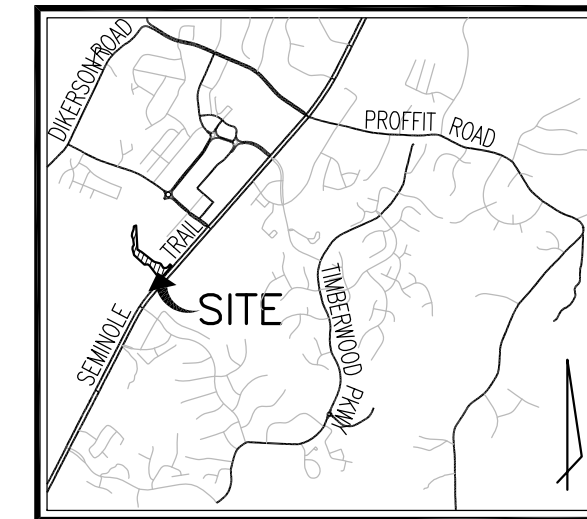

VICINITY MAP  
SCALE: 1"=4,000'

PARCEL ID 04600-00-00-00500  
**ROUTE 29, LLC**  
DEED BOOK 3801 PAGE 616

PARCEL ID 04600-00-00-005A0  
**COUNTY OF ALBEMARLE, VIRGINIA**  
DEED BOOK 3997 PAGE 637



PARCEL ID 03200-00-00-04500  
**ROUTE 29 LLC**  
DEED BOOK 3801 PAGE 616

PARCEL ID 04600-00-00-00600  
**MOONEY 29 NORTH LLC**  
DEED BOOK 4244 PAGE 494

**AREA TABULATION**

PERMANENT UTILITY EASEMENT	3,795 S.F. OR 0.0871 ACRES
TEMPORARY ACCESS EASEMENT	1,452 S.F. OR 0.0333 ACRES
TEMPORARY CONSTRUCTION EASEMENT	28,239 S.F. OR 0.6483 ACRES

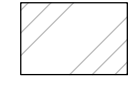
**LEGEND**

-  PERMANENT UTILITY EASEMENT
-  TEMPORARY ACCESS EASEMENT
-  TEMPORARY CONSTRUCTION EASEMENT

**SURVEYOR'S CERTIFICATE**

I, NICHOLAS KOUGOULIS, A DULY LICENSED LAND SURVEYOR IN THE COMMONWEALTH OF VIRGINIA, DO HEREBY CERTIFY THAT THE PROPERTY SHOWN HEREON IS NOW IN THE NAME OF COUNTY OF ALBEMARLE, VIRGINIA AS RECORDED IN DEED BOOK 3997 AT PAGE 637 AMONG THE LAND RECORDS OF ALBEMARLE COUNTY, VIRGINIA.

NICHOLAS KOUGOULIS  
LAND SURVEYOR

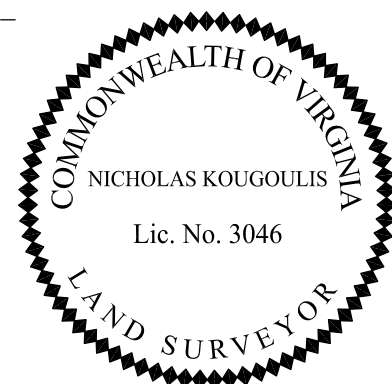

PLAT SHOWING A  
**TEMPORARY CONSTRUCTION EASEMENT,  
TEMPORARY ACCESS EASEMENT AND  
PERMANENT UTILITY EASEMENT**  
TO BE ACQUIRED BY  
**THE ALBEMARLE COUNTY  
SERVICE AUTHORITY**  
ON THE LAND OF  
**COUNTY OF ALBEMARLE, VIRGINIA**  
RIVANA MAGISTERIAL DISTRICT  
ALBEMARLE COUNTY, VIRGINIA  
SCALE: 1"= 30' AUGUST 6, 2021  
SHEET 1 OF 2

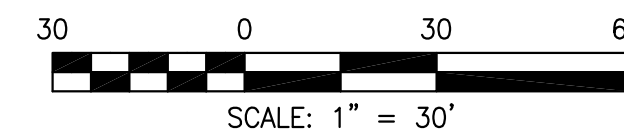

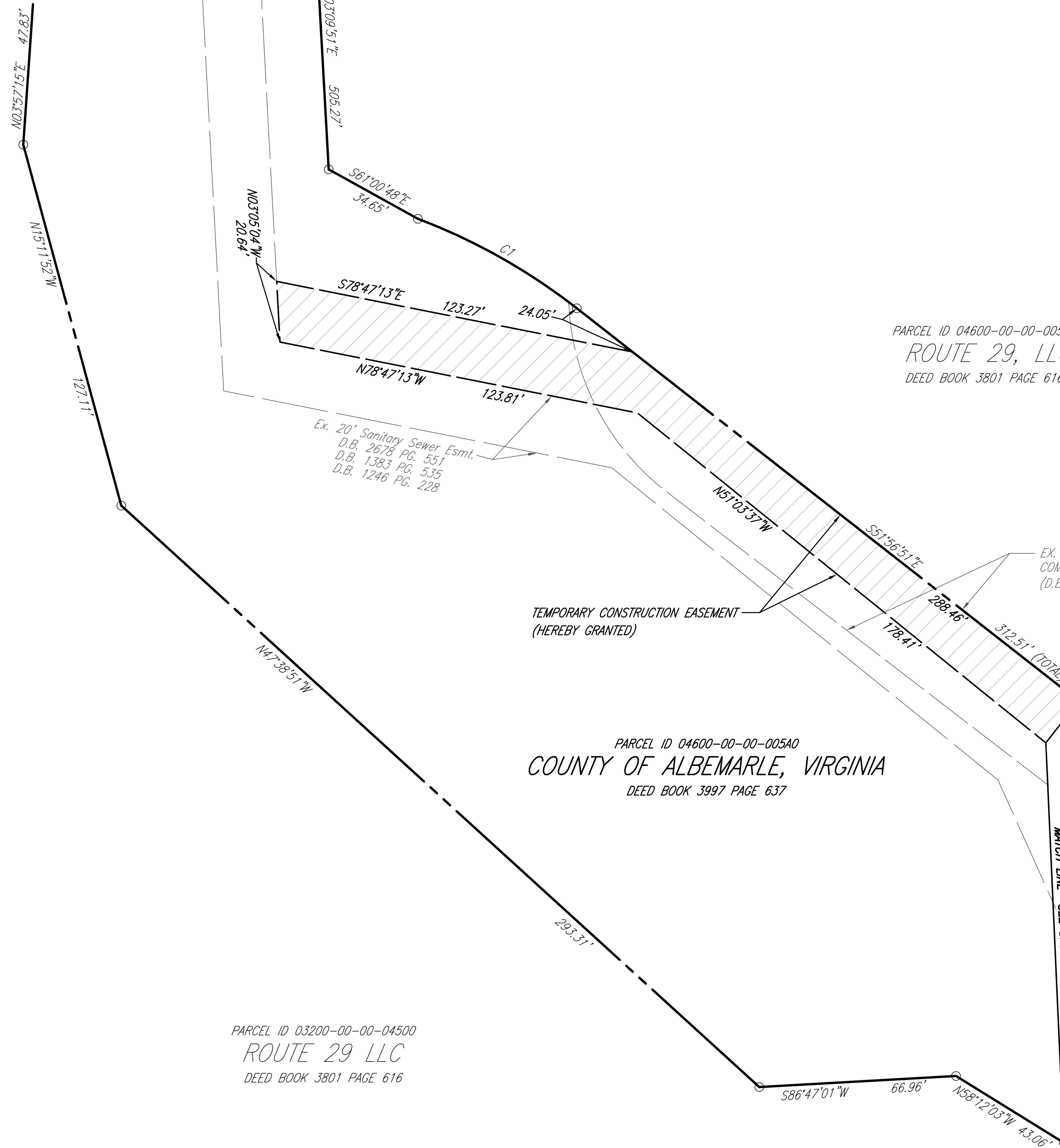



PARCEL ID 04600-00-00-00500  
 ROUTE 29, LLC  
 DEED BOOK 3801 PAGE 616

PARCEL ID 04600-00-00-005A0  
 COUNTY OF ALBEMARLE, VIRGINIA  
 DEED BOOK 3997 PAGE 637

PARCEL ID 03200-00-00-04500  
 ROUTE 29 LLC  
 DEED BOOK 3801 PAGE 616

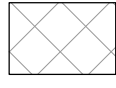
VCS 1983 NORTH (SOUTH ZONE)

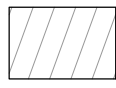
- LEGEND**
-  PERMANENT UTILITY EASEMENT
  -  TEMPORARY ACCESS EASEMENT
  -  TEMPORARY CONSTRUCTION EASEMENT

PLAT SHOWING A  
 TEMPORARY CONSTRUCTION EASEMENT,  
 TEMPORARY ACCESS EASEMENT AND  
 PERMANENT UTILITY EASEMENT  
 TO BE ACQUIRED BY  
 THE ALBEMARLE COUNTY  
 SERVICE AUTHORITY  
 ON THE LAND OF  
**COUNTY OF ALBEMARLE, VIRGINIA**  
 RIVANNA MAGISTERIAL DISTRICT  
 ALBEMARLE COUNTY, VIRGINIA  
 SCALE: 1" = 30' AUGUST 6, 2021  
 SHEET 2 OF 2

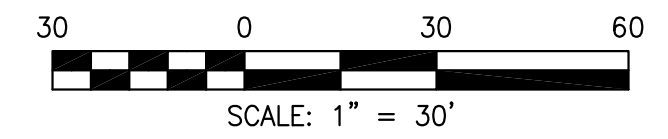
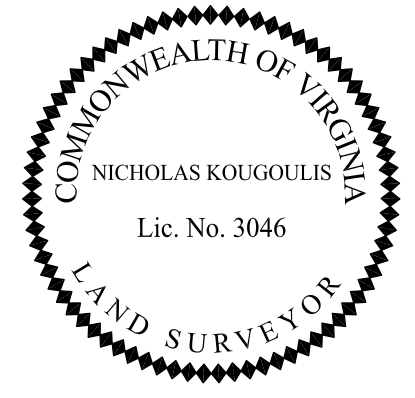

Engineering \* Surveying \* Land Planning \* Transportation \* Environmental Services  
 11100 Endeavor Court, Suite 200, Mechanicsville, VA 20109, on the web @ www.rdacl.com  
 Telephone: (703) 388-2373 Fax: (703) 257-5443  
 "Turning Challenges into Opportunities"

**Rinker Design Associates, P.C.**